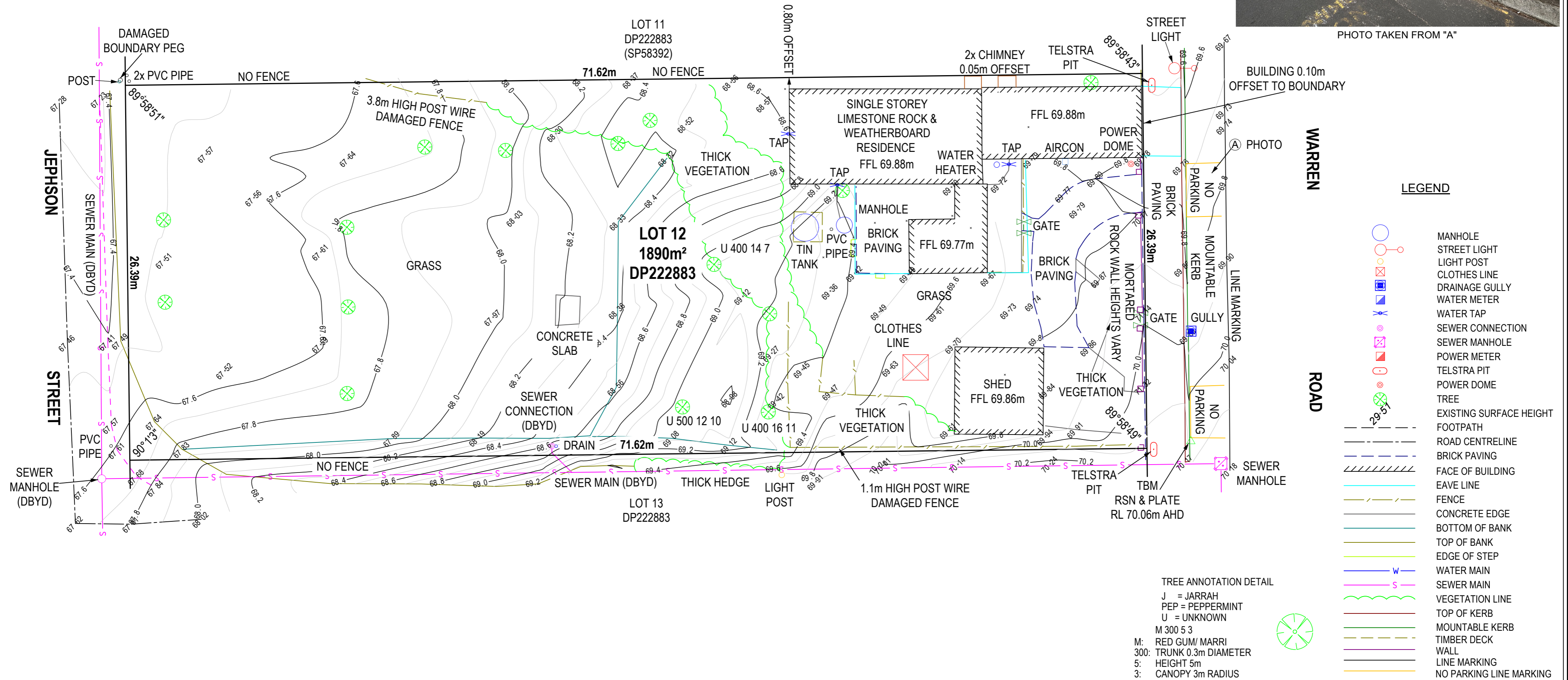



PHOTO TAKEN FROM "A"



- NOTES:**
- Limited boundary marks found. Boundary resurvey recommended if building on or close to boundary.
 - Datum is AHD established from VRS / GPS.
 - Above ground services located by survey. Underground services plotted from plans supplied by the relevant authorities. No liability is accepted for errors in underground service locations. All services to be located on site prior to any work being done.
 - No boundary marks found unless otherwise noted.
 - Contour interval is 0.1m
 - PDF to be used in conjunction with DWG file supplied. Some point heights may have been omitted for clarity; see DWG file.

Rev.	Initial Issue	GM	26/10/2023	MR
A	INITIAL ISSUE	GM	26/10/2023	MR
	Description	Drawn	Date	Checked

Scale: 1:200 A2 ORIG ALL DISTANCES IN METRES

Surveyor: GM
 Survey date: 26/10/2023
 Precal/Cad: N/A

The contents of this plan are dated within the revision panel. All consultants and persons wishing to utilise this data should satisfy themselves of this plan's currency by contacting Survcon.

The boundaries depicted on this plan were not re-established as part of this survey, therefore this plan does not guarantee their accuracy. Re-establishment of the cadastral boundaries is recommended for any proposed works on or near existing boundaries.

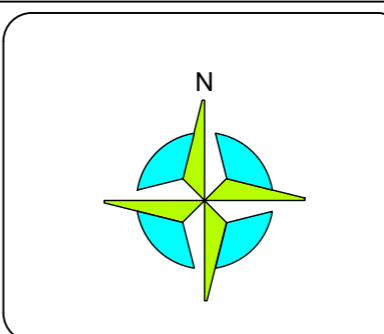

FEATURE AND CONTOUR SURVEY
LOT 12 ON DEPOSITED PLAN 222883,
30 WARREN ROAD, NANNUP.

Client: **ELITE COMPLIANCE**

SURVCON SURVEYING SERVICES

PO Box 365
 Dunsborough WA 6281
 Australia

Tel: (08) 9754 1188
 Fax: (08) 9756 8000
 mail@survcon.com.au
 www.survcon.com.au

PROJ MNGR. Michael Riddle DATUM MGA2020 AHD

9322_SS_A
 JOB NUMBER TYPE REVISION