



# AGENDA

Council Meeting to be held  
on Thursday 22 April 2010



# ***Shire of Nannup***

## **NOTICE OF AN ORDINARY COUNCIL MEETING**

Dear Council Member,

The next Ordinary Meeting of the Shire of Nannup Council will be held on Thursday 22 April 2010 in the Council Chambers, Nannup commencing at 4.15 pm.

Schedule for 22 April 2010:

- 2.45 pm Vik Cheema (FESA) - Presentation on Emergency Management for Local Government and for Shire of Nannup
- 3.15 pm Information Session
- 4.15 pm Meeting commences
- 7.00 pm Dinner.

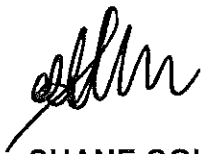

**SHANE COLLIE  
CHIEF EXECUTIVE OFFICER**

# Agenda

1. DECLARATION OF OPENING/ANNOUNCEMENT OF VISITORS
2. RECORD OF ATTENDANCE/APOLOGIES/LEAVE OF ABSENCE  
(previously approved)
3. RESPONSE TO PREVIOUS PUBLIC QUESTIONS TAKEN ON NOTICE

The following questions were submitted by Dr Bob Longmore at Council's March 2010 meeting and were taken on notice. Responses have been provided to Dr Longmore as indicated below.

Q 1. The name lilly pilly is generic in the sense that there are many different species and varieties, and one would be selected which would be most suitable for the purpose. I draw her attention to the white fruited lilly pilly trees gracing the Pemberton main park and which don't seem to present an environmental hazard to that Council. Would her objections continue if that tree was withdrawn from the lists?

A 1 *Cr Camarri has advised that the intent of her Notice of Motion (Rescission) was to permit further consultation and to ensure that trees that are planted today do not become a problem for future generations down the track. Cr Camarri has responded in general terms regarding appropriate trees in appropriate places to ensure the correct outcome, a view one would expect is shared by all.*

*It may take a little while longer to finalise the list and location and it is important that Council get it right and that a suitable policy be developed.*

*Cr Camarri also made reference to the recent example in Perth (Thornlie) where the wrong tree was planted in the wrong place.*

Q 2. Has Cr Camarri taken note of the fact that there are many different species and varieties of 'poplar' and that the one named, ie the Simons poplar, *Populus simonii*, is a non-suckering tree, contrary to her statement that it may "become an environmental weed, requiring regular slashing to control offspring".

A 2 *Refer response question 1.*

Q 3. I request Cr Camari to proffer evidence that the Chinese white birch, *Betula szechuanica*, has the potential to become an environmental weed. Do the silver birches at present in the Caravan Park present that same hazard?

A 3 *Refer response question 1.*

Q 4. Cr Camarri states that "input into location and species type from Council's gardening staff was minimal". On the contrary, Steve Winfield is a significant member of the Arboretum Working Party, and indeed tabled the plant lists which were used to select suitable trees. This was a working party of selected interested persons. Can I ask Cr Camarri to suggest any other Council gardening staff who should be included in future deliberations?

A 4. *The intent of Cr Camarri's rescission motion which was supported by Council was to provide feedback to the Working Party, Council's Gardening staff and any other interested stakeholder in order that a future recommendation on both tree species and location can be formulated and submitted to Council.*

Q 5. Has Cr Camarri consulted the Golden Valley Tree Park management to confirm her misgivings on the trees the working party selected?

A 5. *It is understood not.*

Q 6. Regarding her statement that "the site is inappropriate" - Can Cr Camarri provide reasons why that area is inappropriate? Large trees already grow there, and new trees have been planted in the recent past. It has been recently noted in other shires that deciduous trees may provide a degree of protection to an area during an advancing forest fire.

A 6. *Cr Camarri has indicated that feedback through Council's Works Manager and Gardener had raised some concerns with the location hence rescinding the motion would allow further clarification.*

#### **4. PUBLIC QUESTION TIME**

#### **5. APPLICATIONS FOR LEAVE OF ABSENCE**

#### **6. PETITIONS/DEPUTATIONS/PRESENTATIONS**

#### **7. CONFIRMATION OF MINUTES OF PREVIOUS MEETINGS**

That the Minutes of the Ordinary Council Meeting of the Shire of Nannup held in Council Chambers on 25 March 2010 be confirmed as a true and correct record.

**8. ANNOUNCEMENTS BY PRESIDING MEMBER WITHOUT DISCUSSION****9. REPORTS BY MEMBERS ATTENDING COMMITTEES****10. REPORTS OF OFFICERS**

Agenda No.	Description	Page No.
<b>DEVELOPMENT SERVICES</b>		
10.1	Reformatting of Local Planning Policies	6
10.2	Existing Policies Converted to Local Planning Policies	8
10.3	New Local Planning Policies	14
<b>FINANCE &amp; ADMINISTRATION</b>		
10.4	Forward Plan 2010/11 to 2014/15	18
10.5	Monthly Financial Statements for 31 March 2010	23
10.6	Risk Management Advisory Committee	24
10.7	Early Learning Centre, Nannup	26
10.8	Nannup Bike Rack Project	28
10.9	Accounts for Payment	30

**11. NEW BUSINESS OF AN URGENT NATURE INTRODUCED BY DECISION OF MEETING**

- (a) OFFICERS
- (b) ELECTED MEMBERS

**12. ELECTED MEMBERS MOTIONS OF WHICH PREVIOUS NOTICE HAS BEEN GIVEN****12.1 Community Resource Centre**

The following notice of motion was included in the January, February and March 2010 agendas and was requested to be laid on the table by the mover Cr Mellema;

Cr Mellema

I move that:

*"the Shire of Nannup commence an investigation for the provision of a "purpose-built" Community Resource Centre facility to house the Telecentre that will cater for their current and anticipated needs for the short to medium term in the future in addition to providing for future extensions for other community purposes.*

*As part of the investigation, Council will undertake the following:*

- *Identification of possible suitable sites*
- *Independent preparation of a needs analysis*
- *Independent preparation of a feasibility study*
- *Preparation of concept plans and indicative costing*
- *Extensive community consultation to gauge the level of community support for a Community Resource Centre against other proposed major infrastructure projects (estimated costs of each project to be detailed and how each project is to be funded included in, the survey)*
- *If the Community Resource Centre attains the highest priority, a quantity surveyor's report on the proposed concept plans to be prepared*
- *Funding sources to be identified and finalised*
- *Tenders called for architects*
- *Tenders or quotes for project management*
- *Tenders for construction"*

**Justification for the Notice of Motion (Cr Mellema):**

1. Council recognises that the current Telecentre facility is insufficient to meet the current needs of the community for the following reasons:
2. The infrastructure being used was the old hall supper room and any proposal to extend the building to cater for the Telecentre's future requirements is constrained by the location of the Town hall's effluent disposal holding tanks and drains and setback limits on the site.
3. To provide proper training facilities, a Telecentre requires a training room separate from the public area to allow students uninterrupted time.
4. A training room can also be utilised for video-conferencing purposes etc.
5. A separate area for internet cafe purposes is also desirable to allow users greater privacy than currently available.

**Other Comments (Cr Mellema):**

The location of a new Community Resource Centre should, if at all possible, have main street frontage to maximise the accessibility to the public, however careful consideration of any proposed site should ensure that the site should be capable of not only accommodating the building but also all parking required under the Nannup Town Planning Scheme #3 without reallocating some of it in other areas of the townsite.

The site should also have considerable room for extensions for other community purposes in the future without compromising the provision of parking onsite.

Any such site should be situated so as to avoid any complications associated with the 1 in 100 year flood level.

### **12.1 Eucalyptus Trees in Marinko Park**

Cr Camarri has put forward the following Notice of Motion:

*"That Council budget to remove the Eucalyptus Trees in Marinko Tomas Park which are considered a liability by the Works Manager, and Parks and Gardens Manager."*

### **Officer Comment (Works Manager)**

Councils Forward Plan contains an Action Plan which recognises this and a draft budget amount 2010/11 (and beyond) will include a monetary figure for consideration over the next 5 years to complete the removal and replacement of the trees in question.

**13. QUESTIONS BY MEMBERS OF WHICH DUE NOTICE HAS BEEN GIVEN**

**14. CLOSURE OF MEETING**



# **DEVELOPMENT**

# **SERVICES**

AGENDA NUMBER: 10.1  
SUBJECT: Reformatting of Local Planning Policies  
LOCATION/ADDRESS:  
NAME OF APPLICANT:  
FILE REFERENCE: TPL10  
AUTHOR: Shane Collie – Chief Executive Officer  
DISCLOSURE OF INTEREST:  
DATE OF REPORT: 13 April 2010

Attachments:           1. LPP 001 Cut & Fill and Retaining Wall Policy.  
                              2. LPP 017 Subdivisional Development Guidelines Policy.

## **BACKGROUND:**

Since Council adopted its Local Planning Scheme # 3 (LPS 3), it is necessary to review all policies (and in particular planning policies) and where necessary amend them to reflect changes within the Scheme. This includes references to the old scheme, and where there is conflict between the new scheme and existing policies, or to develop new policies as required.

## **COMMENT:**

The two policies attached remain current and only need minor formatting/presentation changes to bring them into line with LPS 3 as Local Planning Policies. This has been undertaken and the policies are hence provided for reaffirmation by Council as Local Planning Policies. The original adoption dates of these two policies were as follows:

Cut & Fill and Retaining Wall Policy	23 April 2009.
Subdivisional Development Guidelines Policy	25 September 2008.

LPS 3, clause 2.2 permits Council to prepare Local Planning Policies to assist with the making of decisions under the Schemes provisions. Planning Policies are being renumbered using the prefix of LPP.xxx to clearly identify them as being Local Planning Policies as distinct from other policies of Council.

There is no advertising requirement for these two policies as they have already been through that process and there is no alteration to text or intent.

**STATUTORY ENVIRONMENT:**

Shire of Nannup Local Planning Scheme No.3 Clause 2.4 and Local Government Act 1995 section 2.7.

**POLICY IMPLICATIONS:**

Existing policies reviewed and reformatted to become Local Planning Policies.

**FINANCIAL IMPLICATIONS:** Nil.

**STRATEGIC IMPLICATIONS:**

Council' draft Forward Plan 2010/11 to 2014/15 contains sub program 10.2 (Town Planning) with an Action Title:

*"Develop and implement appropriate planning strategies in accordance with the relevant legislative parameters."*

**RECOMMENDATION:**

That Council reaffirm existing Council policies attached –

Cut & Fill and Retaining Wall Policy  
Subdivisional Development Guidelines Policy

as Local Planning Policies LPP001 and LPP 017 respectively.

**VOTING REQUIREMENTS:**



**SHANE COLLIE  
CHIEF EXECUTIVE OFFICER**



<b>Policy Number:</b>	LPP.001
<b>Policy Type:</b>	Local Planning policy
<b>Policy Name:</b>	Cut & Fill and Retaining Wall Policy
<b>Policy Owner:</b>	Manager Development Services

Authority Shire of Nannup Local Planning Scheme No.3

---

## 1.0 Introduction

The natural topography of the Shire of Nannup provides a number of challenges to land owners and developers, in particular finding level building sites in some areas. To create these level sites cut and fill techniques are often used along with the development of retaining walls.

This is more easily addressed at subdivision stage where the systematic development of retaining walls can be addressed for the whole of the land. More problematic is where individual landowners seek to establish retaining walls and the impacts unregulated designs and finishes will have on immediate neighbours and the locality as a whole.

It is becoming increasingly apparent that the management of these forms of development has not been sufficient.

This policy has been formulated to provide a set of guiding principles for landowners, developers and Shire staff in respect to where 'cut and fill' of residential land in the Shire is sought and specifically, where retaining walls and the like are sought.

## 2.0 Objectives

The principal objectives of this Policy are:

- To preserve the natural topography of the Scheme Area by restricting the level of cut and fill development specifically on steep slopes which may be more suitable to other construction techniques (i.e.: pole homes, stump system, retaining walls.)
- To ensure that at subdivision stage, an assessment is undertaken as to the likely need for cut and fill and/or the development of retaining walls based on the slope of the land, lot size and vegetation cover prior to clearance of WAPC subdivision conditions.
- To ensure that where individual landowners seek to undertake cut and fill and/or the development of retaining walls on boundaries, the assessment provided in this Local Planning Policy is undertaken.

### 3.0 Application of this Policy

Table 3 of the *Residential Planning Codes ('R Codes')* would normally require a minimum setback to a common boundary of 1.5m for a 'building' that is 2.4m in height. Under the *R Codes*, a 'retaining wall' is defined as a 'building'. Any modification is addressed under the *R Codes* as follows:

#### *"2.4 Discretionary decisions*

*In relation to the codes, discretionary decisions shall be decisions made by the council with respect to any aspect of a proposed development that varies from the relevant acceptable development provision or a provision of a local planning policy.*

#### *2.5 Exercise of discretion*

*2.5.1 Where codes approval is required, the applicant shall make an application in accordance with the form set out in appendix 2 to the council for approval. Subject to clauses 2.5.2 and 2.5.3, the council is to exercise its discretion in considering such applications having regard to the considerations, standards and requirements provided in the codes.*

*2.5.2 Discretion shall be exercised having regard to the following considerations:*

- (a) the stated purpose and aims of the scheme;*
- (b) the provisions of parts 1-7 of the codes, as appropriate;*
- (c) the performance criterion or criteria in the context of the coding for the locality that corresponds to the relevant provision;*
- (d) the explanatory guidelines of the codes that correspond to the relevant provision;*
- (e) any local planning strategy incorporated into the scheme;*
- (f) a provision of a local planning policy pursuant to this policy and complying with clause 2.5.3; and*
- (g) orderly and proper planning."*

The Policy applies to all applications relating to site development of residential land where cut and fill resulting in the construction of retaining walls associated with private residential development within the Shire of Nannup, is sought.

### 4.0 Relationship to Other Policies

This Policy should be read in conjunction with all Council Policies and the Shire of Nannup Local Planning Scheme No.3 (as amended).

This Policy is adopted pursuant to clauses 2.2, 2.3 and 2.4 of the Shire of Nannup Local Planning Scheme No.3 (as amended).

## 5.0 Interpretations

- **“Terrace”** – for the purpose of this policy a “terrace” is a series of flat platforms (or steps) on the side of a hill, rising one above the other. The base of the terrace is taken to be the bottom of the lowest step with the top being the highest point of the highest step.
- **“Topsoil”** - for the purpose of this policy “topsoil” is taken to be the soil zone containing decomposed organic matter and seed source, generally not to exceed 150mm in depth.
- **“Unprotected Embankment”** – for the purpose of this policy an “unprotected embankment” is taken to be the face area of a section of fill that is not subject to retaining or other forms of stabilisation.

## 6.0 Policy Provisions

In assessing a proposal the Shire shall consider the following:

- 6.1.1 Where Council suspects that unstable soil and site conditions occur, or the slope is greater than 1:5 Council will require a geotechnical report and a structural engineer's report to determine building construction requirements.
- 6.1.2 No land over 1:4 slope prior to grading shall be developed using cut & fill construction techniques, except at the specific discretion of Council and where it can be shown that a minimum amount of development is in the spirit and not incompatible with the objectives of this policy.
- 6.1.3 The specific policy requirements that apply to all land within Local Planning Scheme No. 3 as set out below:
  - Access tracks are to be located in such a manner as to minimise the required earthworks.
  - All exposed earthworks will be required to be landscaped in accordance with an approved landscaping plan (see section 6.4).
  - Topsoil is to be stripped separately and stockpiled on site, to be respread during landscaping.
  - Water discharge from the site during development is to be controlled by the use of ripping, contour banks or grade banks and sumps to attenuate turbid and/or nutrient rich water leaving the site.
  - Where a residence is to be constructed partially on cut and partially on fill, the excavated material is to be placed outside the building area to form

batters and embankments and the platform is to be filled with sand. Consolidated in even lifts, not exceeding 600mm, to produce a density which will resist seven blows per 300mm of standard 16mm diameter penetrometer. As an alternative, pile and beam foundations into natural uncut ground in the fill area are acceptable.

- Fill is not to exceed 1.5m at any given point on the site and the top level of the fill is not to exceed 2.4m from the base of the fill.

## 6.2 Retaining wall requirements

6.2.1 Unless otherwise provided for within this policy, retaining walls will be required where cut or fill is equal to, or in excess, of 1.0 metre. Note: Owners and developers need to observe health and safety requirements

6.2.2 A retaining wall is not to exceed 2.4m in height (measured from the base of the wall).

6.2.3 Where it is proposed to terrace a portion of a lot the policy provisions set out above apply in so far that where a step is in excess of 1m retaining will be required and the top level of the terrace is not to exceed 3.0 from the base of the terrace.

6.2.4 Where an unprotected embankment is proposed no retaining will be required where it is in accordance with BCA Volume 2 Part 3.1.1 – Earthworks (note Attachment 1). Such embankments are to be landscaped in accordance with an approved landscaping plan.

6.2.5 Land owners and developers should note their 'Health and Safety' responsibilities with regards to retaining walls during construction and on completion. Provision for safety fencing in accordance with the BCA P2.5.2 – Barriers.

## 6.3 Landscaping plan requirements

6.3.1 Where a landscaping plan is required it is to include:

- list of species to be used;
- location of planting;
- location of reticulation areas;
- location of compensating basins/sumps;
- areas to be direct seeded/mulched;
- species used in a seed mix (if applicable);
- timing of revegetation program; and

- fertiliser use is to be specified (including the type of fertiliser, application rates, method of application and timing of application).

## 7.0 Application Details

### 7.1 Subdivision Development

7.1.1 Where as part of the overall subdivision and development of land, any permanent excavation with a slope steeper than the angle of repose or natural slope of the soil shall have retaining walls of masonry or other materials approved by the Shire of sufficient strength and stability to retain the embankment together with any surcharged loads.

7.1.2 Design of the retaining structure is to be by a practising Civil or Structural Engineer with certified engineering drawings to be submitted to Shire for approval.

7.1.3 Information to be supplied with the engineering assessment will include but not be limited to the following:

- a site plan showing the main topographical features of the site including slope;
- contours and drainage lines;
- vegetation;
- dams and water courses;
- rock outcrops;
- soil type,
- fences
- buildings;
- level of top of sand pad/fill;
- finish floor level;
- cut and fill section showing sub soil drainage and cut off drains;
- cut and fill section (of greatest cut and fill) showing method of retention;
- landscaping plan (if required);
- design and construction details of any retaining walls (if required) which shall be prepared by a suitably qualified structural engineer; and
- other details required elsewhere within this Local Planning Policy

7.1.4 The Shire will determine the type and colour of materials to be used forming the retaining wall. In considering the type and colour of materials, the Shire may require the subdivider to undertake a visual assessment to the requirements of the Shire. In addition, any brick or block work undertaken will be required to have a 'clean' finish to the adjoining lot.

## 7.2 Individual Lots

- 7.2.1 Where any permanent excavation with a slope steeper than the angle of repose or natural slope of the soil shall have retaining walls of masonry or other materials approved by the Shire of sufficient strength and stability to retain the embankment together with any surcharged loads.
- 7.2.2 Design of the retaining structure by a practising Civil or Structural Engineer will be required and shall be submitted to Shire for approval prior approval of a Building Licence.
- 7.2.3 Information to be supplied with the engineering assessment will include but not be limited to the following:
- contours of site;
  - level of top of sand pad/fill;
  - finish floor level;
  - cut and fill section showing sub soil drainage and cut off drains;
  - cut and fill section (of greatest cut and fill) showing method of retention;
  - drainage;
  - landscaping plan (if required);
  - design and construction details of any retaining walls (if required) which shall be prepared by a suitably qualified structural engineer;
  - provisions of the Residential Planning Codes; and
  - other details required elsewhere within this Local Planning Policy
- 7.2.4 Where a retaining wall in the Residential zone is proposed on a boundary, a Licensed Surveyor must be employed by the landowner to set out the boundaries prior to the commencement of any works. In this regard, the requirement for a Licensed Surveyor will be included as a condition of Building Licence.
- 7.2.5 The Shire will determine the type and colour of materials to be used forming the retaining wall. Generally, the type of retaining wall structure will be of 'earth' tones and normally not include concrete blocks or similar.

In relation to the development of land forming the 'Hines' subdivision, retaining walls will be in accordance with the endorsed Development Guide Plan as included in Attachment 2 and ensure that the buildings are in 'earthy tones' and not limestone in colour. Examples of colours that are acceptable include Dulux®:

- Latte;
- Ground Coriander;
- Stucco Tan; and
- Nubuck;



as per the colour chart included as Attachment 3.

Other colours may also be acceptable and in this regard, it is recommended that you closely liaise with the Shire.

\* Dulux® is a Registered Trademark

In addition, any brick or block work undertaken will be required to have a 'clean' finish to the adjoining lot.

7.2.6 As part of the assessment process, consultation is to be undertaken. Council will require applicants to supply written support from adjoining landowners specifically implicated by the proposed retaining wall. Where written comments are not able to be obtained by the applicant, staff will provide written advice to adjoining landowners and community groups (at the applicants cost) of the proposed construction and invite them to submit comments to the Shire.

7.2.7 If an adjoining landowner or community group does not respond within the time provided (generally 21 days), the Shire will consider the application on the basis that the landowner has not exercised their opportunity to comment.

7.2.8 Where objections are received the submission(s) will be reviewed and considered in light of the applications relevance against the Local Planning Scheme No. 3 and the provisions of this policy.

#### Attachments:

1. Building Codes of Australia Table 3.1.1.1
2. Subdivision Guide Plan Lot 23 Brockman Highway – P0486-01(SGP) dated July 2006.
3. Dulux® colour chart

Related Policies	
Related Procedures/Documents	
Delegated Level	CEO/CEO to Manager Development Services & Building
Adopted	OM 23 April 2009 Resolution 8157
Reviewed	

**ATTACHMENT 1**  
**TO LPP001**  
**DATED 23 APR 09**

**UNPROTECTED EMBANKMENTS**

Notes: For the purposes of this Table:

1. Retaining walls or other types of soil retaining methods must be installed where -
  - (a) the slope ratio is more than that described in Table 3, 1, 1.1; or
  - (b) the soil type is not described in this Table.
2. Embankments that are to be left exposed at the end of the construction works must be stabilised by vegetation or similar works to prevent soil erosion.

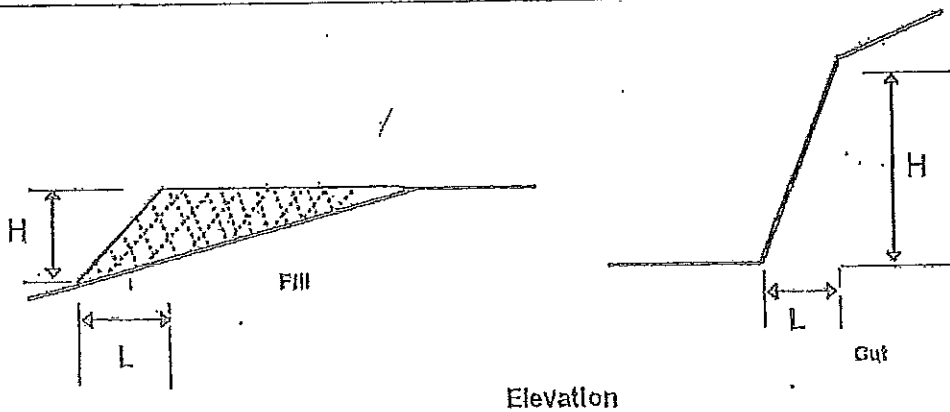

SOIL TYPE (*see Part 3.2.4 for material description)		EMBANKMENT SLOPES H:L	
		Compacted fill (see Part 3.2)	Cut
Stable rock (A <sup>o</sup> )		2:3	8:1
Sand (A <sup>o</sup> )		1:2	2:3
Silt (P <sup>o</sup> )		1:4	1:4
Clay	Firm clay	1:2	1:1
	Soft clay	Not suitable	2:3
Soft soils (P <sup>o</sup> )		Not suitable	Not suitable

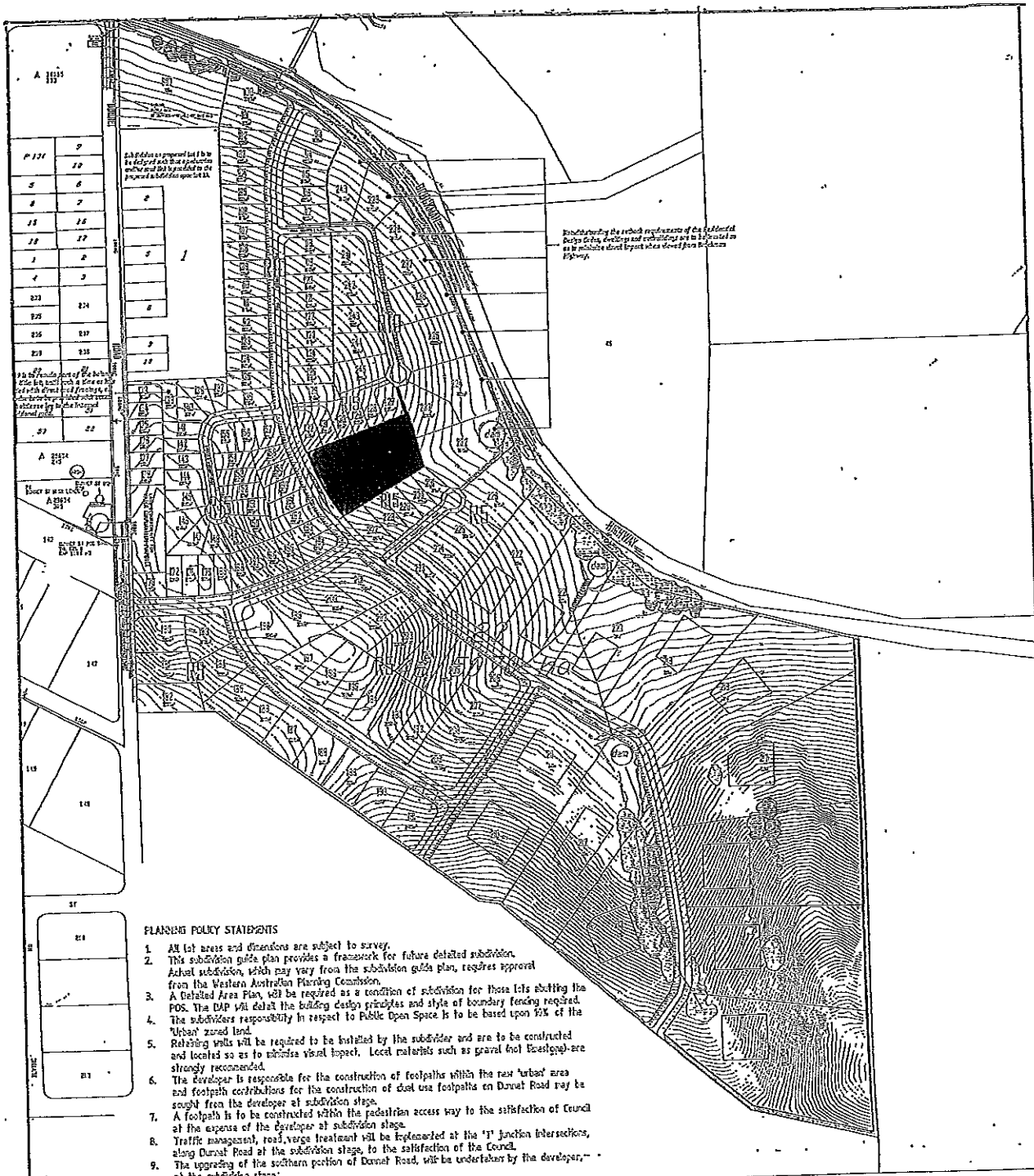

- PLANNING POLICY STATEMENTS**
1. All lot areas and dimensions are subject to survey.
  2. This subdivision guide plan provides a framework for future detailed subdivision. Actual subdivision, which may vary from the subdivision guide plan, requires approval from the Western Australian Planning Commission.
  3. A Detailed Area Plan, will be required as a condition of subdivision for those lots abutting the POS. The DAP will detail the building design principles and style of boundary fencing required.
  4. The subdividers responsibility in respect to Public Open Space is to be based upon 5% of the 'Urban' zoned land.
  5. Retaining walls will be required to be installed by the subdivider and are to be constructed and located so as to minimise visual impact. Local materials such as gravel (not limestone) are strongly recommended.
  6. The developer is responsible for the construction of footpaths within the new 'urban' area and footpath contributions for the construction of dual use footpaths on Durnal Road may be sought from the developer at subdivision stage.
  7. A footpath is to be constructed within the pedestrian access way to the satisfaction of Council at the expense of the developer at subdivision stage.
  8. Traffic management, road verge treatment will be implemented at the 'T' junction intersections, along Durnal Road at the subdivision stage, to the satisfaction of the Council.
  9. The upgrading of the southern portion of Donner Road, will be undertaken by the developer, at the subdivision stage.

**LEGEND**

	subject property		strategic fire break (6m wide)
	vegetation buffer 3m (consisting of shrubs and trees)		residential density code
	remnant vegetation		building envelope
	revegetation - avenue of trees		footpath
			Stage 1 - WAPC Approval (May 01, 2006)

Source: cadastre information plotted from Water Corporation data, contour information plotted from Lesgale data.

**SUBDIVISION GUIDE PLAN**  
**LOT 23 BROCKMAN HIGHWAY**  
**NANNUP**

↑  
North

SCALE: 1:4000  
 DATE: July 2006  
 PLAN NO: P0486-01[SGP]  
 Rev.5

**PETER D WEBB AND ASSOCIATES**

**CONSULTANTS IN TOWN PLANNING & URBAN DESIGN**  
 PO BOX 920 SUBIAGO WA 6904 TEL: 9388 7111  
 UNIT 2/19 YORK STREET SUBIAGO FAX: 9388 7240

**ATTACHMENT 3**  
**TO LPP001**  
**DATED 23 APR 09**

Suede Nouveau

Natural Wheat

Copper

Latta

Charmed Lula

Almond Sault

Stucco Tan

Lava Crust

Chestnut Spice

Taurus Red

Bouffue Stone

Crushed Walnut

Creek Bark

Tuxedo

Pompeii Ash

Aspen Mist

Plum Fusion

Mocha Earth

Rare Onyx

Charcoal Chintz

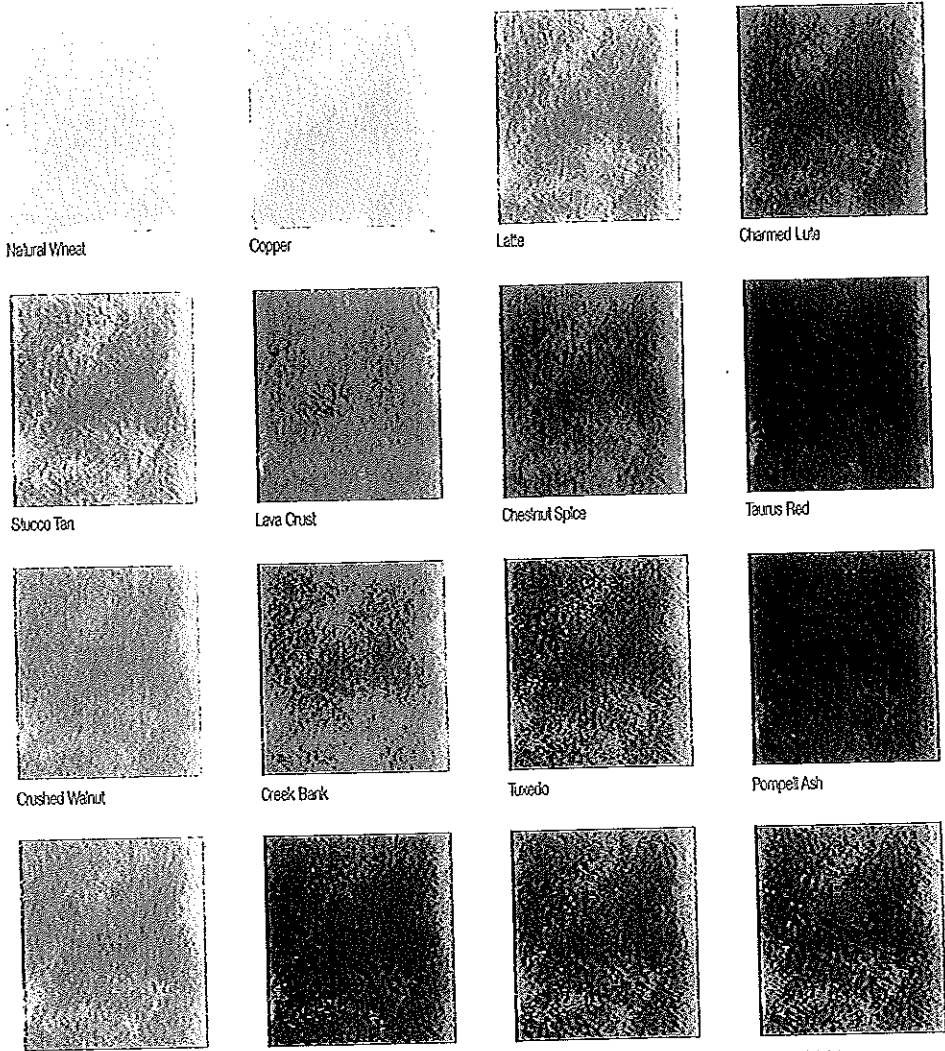



<b>Policy Number:</b>	LPP.017
<b>Policy Type:</b>	Local Planning Policy
<b>Policy Name:</b>	Subdivisional Development Guidelines Policy
<b>Policy Owner:</b>	Manager Development Services

Authority: Shire of Nannup Local Planning Scheme No3

**Objective:**

1. To provide guidelines for the design and construction of subdivisional works for developers.

**Definitions:**

2. Nil

**Policy**

3. Council requires that the provision of engineering works associated with the subdivision and development of land within the Shire of Nannup are undertaken in accordance with the adopted Shire of Nannup Subdivisional Development Guidelines.

**Attachment:**

1. Subdivisional Development Guidelines dated May 2008

<b>Related Policies:</b>	
<b>Related Procedures/ Documents</b>	Shire of Nannup Subdivisional Guidelines Local Government Guidelines for Subdivisional Development.
<b>Delegation Level:</b>	CEO, CEO to WM
<b>Adopted:</b>	
<b>Reviewed:</b>	

**MASTER COPY**



**SHIRE OF NANNUP**

**15 Adam Street,  
Nannup WA 6275**

**SUBDIVISIONAL DEVELOPMENT  
GUIDELINES**

**GENERAL CONDITIONS AND GUIDELINES FOR THE  
DESIGN AND CONSTRUCTION OF  
SUBDIVISIONAL WORKS**



## SHIRE OF NANNUP

15 Adam Street,  
Nannup WA 6275

# SUBDIVISIONAL DEVELOPMENT GUIDELINES

GENERAL CONDITIONS AND GUIDELINES FOR THE  
DESIGN AND CONSTRUCTION OF  
SUBDIVISIONAL WORKS

# SHIRE OF NANNUP

## SUBDIVISIONAL DEVELOPMENT GUIDELINES

### Details of new or amended requirements

<b>Clause</b>	<b>Details</b>
<b>SECTION 1:</b>	<b>GENERAL</b>
<b>SECTION 2:</b>	<b>DESIGN PRINCIPLES</b>
<b>SECTION 3:</b>	<b>DRAWINGS</b>
<b>SECTION 4:</b>	<b>CONSTRUCTION OF ROADS</b>
<b>SECTION 5:</b>	<b>CONSTRUCTION OF DRAINS</b>



# SHIRE OF NANNUP

## FOREWORD

This document details Council's requirements for engineering works associated with the subdivision and development of land within the Shire.

It is presented in the form of a guideline to Developers/Subdividers rather than a specification and should not be used by Consultants to replace their Specification. It is performance or results-based, in which the end result is given rather than the means of achieving a desired outcome.

These guidelines were prepared by the Shire's Engineering Section, and comments on any matter contained herein are welcome.

.....  
SHANE COLLIE  
CHIEF EXECUTIVE OFFICER

Date of Original Issue: May 2008

Date of Amendment:

# TABLE OF CONTENTS

<b>SECTION 1 – GENERAL CRITERIA</b> .....	<b>1</b>
<b>1. GENERAL</b> .....	<b>1</b>
1.1 DEVELOPMENT REQUIREMENTS .....	1
1.2 CONTROL AND SUPERVISION OF CONSTRUCTION .....	4
1.3 PRACTICAL COMPLETION OF SUBDIVISIONAL WORKS .....	6
1.4 SURVEY RELEASE.....	6
1.5 BONDING OUTSTANDING WORKS.....	7
1.6 MAINTENANCE.....	8
<b>SECTION 2 – DESIGN PRINCIPLES</b> .....	<b>10</b>
<b>2. DESIGN CRITERIA</b> .....	<b>11</b>
2.1 GENERAL.....	11
2.2 ROADS.....	11
2.3 STORMWATER DRAINAGE .....	21
2.4 MISCELLANEOUS FACILITIES .....	24
<b>SECTION 3 – DRAWINGS</b> .....	<b>27</b>
<b>3. REQUIREMENTS FOR DRAWINGS</b> .....	<b>28</b>
3.1 GENERAL.....	28
3.2 DRAINAGE CALCULATIONS .....	28
3.3 PAVEMENT CALCULATIONS.....	28
3.4 REQUIRED DRAWING SCALES.....	28
3.5 DRAWING INFORMATION.....	29
<b>SECTION 4 – CONSTRUCTION OF ROADS</b> .....	<b>32</b>
<b>4. CONSTRUCTION OF ROADS AND ASSOCIATED WORKS</b> .....	<b>33</b>
4.1 GENERAL.....	33
4.2 SURVEY SET OUT.....	33
4.3 CONSTRUCTION TOLERANCES .....	34
4.4 CLEARING WORKS .....	34
4.5 EARTHWORKS .....	35
4.6 SOIL STABILISATION .....	35
4.6 SUB-GRADE .....	36
4.7 SUB-BASE COURSE .....	37
4.8 BASE COURSE .....	39
4.9 PRIMER SEALING OF PAVEMENT .....	39
4.10 HOT SPRAYED BITUMEN SURFACING .....	41
4.11 CONCRETE KERBING .....	43
4.12 ASPHALT SURFACING .....	45
4.13 STREET NAME PLATES .....	46
4.14 PATH AND ISLAND PAVING .....	46
4.15 LOT FILLING.....	47

<b>SECTION 5 – CONSTRUCTION OF DRAINS .....</b>	<b>49</b>
<b>5. CONSTRUCTION OF DRAINAGE WORKS.....</b>	<b>50</b>
5.1 GENERAL.....	50
5.2 SURVEY SET OUT .....	51
5.3 CONSTRUCTION TOLERANCES .....	51
5.4 MATERIALS .....	51
5.5 INSTALLATION OF MANHOLES AND ROAD GULLIES .....	54
5.6 HEADWALLS AND ENDWALLS.....	56
5.7 PIPE LAYING .....	56
5.8 OPEN DRAINS .....	58
<b>SECTION 6 – SUPERVISION.....</b>	<b>59</b>
<b>6. CONTROL &amp; SUPERVISION OF CONSTRUCTION.....</b>	<b>60</b>
6.1 GENERAL .....	60
6.2 RESPONSIBILITY FOR QUALITY OF CONSTRUCTION .....	60
6.3 SCHEDULE OF INSPECTIONS .....	60
6.4 TESTING & AS CONSTRUCTED SURVEYS.....	61
6.5 PRACTICAL COMPLETION .....	62
<b>SECTION 7 – MAINTENANCE AND SURVEY RELEASE .....</b>	<b>63</b>
<b>7. MAINTENANCE &amp; RELEASE .....</b>	<b>64</b>
7.1 SURVEY RELEASE.....	64
7.2 MAINTENANCE .....	64
<b>SECTION 8 – MATERIAL SPECIFICATIONS.....</b>	<b>66</b>
<b>8. MATERIAL SPECIFICATIONS.....</b>	<b>67</b>
8.1 SPECIFICATION FOR CRUSHED LIMESTONE .....	67
8.2 SPECIFICATION FOR ROAD BASE.....	68
8.3 SPECIFICATION FOR SEALING AGGREGATE .....	69
8.4 SPECIFICATION FOR ASPHALT (BITUMINIOUS CONCRETE).....	70

#### **SCHEDULE OF BOND REQUIREMENTS**

Clause 1.1.9	REINSTATEMENT BOND	3
Clause 1.1.13.2	DUST CONTROL AND SAND DRIFT BOND	34
Section 1.5	OUTSTANDING WORKS BOND	7
Clause 1.6.2	MAINTENANCE BOND	8
Clause 2.3.2.3	PATH CONSTRUCTION BOND	22



## SECTION 1 – GENERAL CRITERIA

## 1. GENERAL

### 1.1 Development Requirements

- 1.1.1 Local Government (Miscellaneous Provisions) Act 1960, Section 295(1) states the following:

“Where a person who is the owner of land in a district proposes to subdivide the land into lots for disposal, if the proposal is to include in the subdivision a street or streets for use by the public, he shall not commence to put the proposal into effect until he has notified the local government of the proposal in writing and delivered to the local government with the notification a plan of the subdivision, and received the approval prescribed by the *Town Planning and Development Act 1928* to do so.”

And Section 295(4)(a):

“Where proposals for the subdivision of land in a district include the provision of streets for use by the public, and the proposals have been approved, .....the owner of the land shall not .....dispose of the land, or part of it, or an estate or interest in it, .....until he has caused those streets to be constructed and drained to the satisfaction of the local government.”

- 1.1.2 Any civil works required to be constructed under the above section of the Local Government Act, shall be constructed to Council requirements as detailed in these guidelines, which comprises a guide to the standard of work and design required before the works will be certified by the Council to the Department of Planning and Infrastructure as having been constructed to the satisfaction of the Council.
- 1.1.3 The terms “Council’s Engineer” or “Engineer” shall mean an Engineer or firm of Consulting Engineers (or their representatives) appointed by Council from time to time to act on its behalf.

The term “Subdivider” shall mean the owner of the land being subdivided or his authorised representative.

The term “Consulting Engineer” or “Consultant” shall mean the Engineer appointed by the Subdivider to design, document and superintend construction of the works. He may be required to furnish proof that he is a qualified Civil Engineer experienced in engineering work associated with the subdivision of land and must be eligible for membership to the Institution Of Engineers (Aust).

1.1.4 Technical provisions included in these Guidelines are intended to provide a guide to the standard of work, materials and design required before roads and drains will be certified to the Western Australian Planning Commission as having been made to the satisfaction of the Council. They are not necessarily complete and are not intended to be used as a specification or contract for construction. They may be subject to alteration with the approval of the Engineer.

1.1.5 The Local Government (Miscellaneous Provisions) Act 1960, Section 295 (6) states:

- “(a) Where a person who is subdividing land is by the provisions of this Part required to construct and drain streets shown in the plan of subdivision he may;
- (i) carry out or cause to be carried out the construction and drainage at his own cost and expense; or
  - (ii) arrange for the Council to carry out the work on his behalf and at his cost and expense.
- (b) Where the person does not make the arrangements with Council, he shall pay to it, on demand, an amount to cover the reasonable costs of the Council in supervising the construction and drainage which amount shall be reckoned as follows:
- (i) where the person has not engaged a Consulting Engineer and Clerk of Works to design and supervise the construction and drainage the amount shall be three percent of the cost of the construction and drainage as estimated by the Council;
  - (ii) where the person has employed a Consulting Engineer and Clerk of Works to design and supervise the construction and drainage, the amount shall be one and one-half percent of the cost of the construction and drainage as estimated by the Council.
- (c) The Council may require the person to employ a Consulting Engineer and Clerk of Works to design and supervise the construction and drainage and that person shall, when required to do so by the Council, carry out the requirement.”

The design, preparation of drawings and specifications, and supervision of construction of subdivision works covered by these requirements shall be undertaken by the Consulting Engineer or his authorised representative. The Consulting Engineer shall carry out a site investigation to determine the geotechnical properties of the soils. Such information shall form the basis of the design of the roads, drainage system and site filling. A copy of this site investigation shall be lodged with the Council prior to or at the same time as drawings are lodged for approval.

- 1.1.7 Where a proposed subdivision abuts an existing road reserve containing a substandard road contained within the road reserve fronting the subdivision, this road shall be upgraded prior to the clearance of the subdivision to the required standard for that particular road as determined by Council's Engineer.
- 1.1.8 Every attempt shall be made to partially or wholly upgrade substandard roads fronting new subdivisions, but where it is impractical to physically construct the road or part thereof in accordance with this policy, the Subdivider shall lodge a non-refundable cash contribution with Council prior to the clearance of the subdivision equal to the estimated cost of the proposed road works.

The Subdivider shall be responsible for all damage to existing facilities, services and structures in both public and private ownership. Any damage shall be repaired to an acceptable standard without delay.

Where the conditions of approval of the subdivision require works to be carried out in an existing road reserve or on other land under Council's control, a permit to construct works in a street shall be obtained from Council and a bond in the form of cash or bank cheque from a financial institution acceptable to Council to cover the reinstatement works of value equal to the estimated cost of the works plus 25% with a minimum of \$1,000, shall be lodged with Council prior to the approval of the drawings and the work commencing, the unused portion of the bond to be returned upon the satisfactory completion of the works. The approval of engineering drawings and specifications shall not constitute permission to carry out works in streets within the Shire.

After clearance of survey diagrams by the Department of Planning and Infrastructure and the Office of Titles, any land delineated and shown as a new road on such diagrams shall come under the control of Council.

- 1.1.12 The supervision fee referred to in Clause 1.1.5 above shall be paid to Council before construction commences.

The amount of the payment shall be based on the estimated cost of all of the works at the time of the commencement of the works. Upon certification of practical completion of the works, the Consultant shall provide the actual construction cost of the works and the amount of the supervision fee shall be adjusted accordingly, if necessary.

- 1.1.13 Drawings and specifications for the construction of roads and drains shall be prepared in accordance with Section 3 of these requirements

and must be approved by Council's Engineer before any work will be allowed to commence.

- 1.1.14 Endorsement of engineering design and drawings by the Shire does not imply fulfilment of planning requirements in any manner and the Shire of Nannup excludes liability for any negligent act or omission in relation to the approval process carried out by the Shire involving the works the subject of the engineering design and drawings.

## 1.2 Control And Supervision Of Construction

- 1.2.1 The construction work shall be carried out in accordance with the approved drawings and specifications, and will be subject to staged inspection and approval by Council's Engineer or his representative during the course of construction. Final approval shall only be given when the whole of the works shown on the approved plans have been executed to the true intent and meaning of the approved drawings and specifications.
- 1.2.2 An inspection is required for each of the following main stages of construction for roads:
- (a) when the road has been boxed out and the subgrade shaped and compacted
  - (b) after the sub-base has been placed, graded and compacted to shape and level
  - (c) when the base has been placed, graded, compacted and water bound to correct shape and level
  - (d) before the priming operation
  - (e) during the kerbing works
  - (f) before the placement of asphalt or sprayed surface course.
- 1.2.3 An inspection is required for each of the following main stages of construction for drainage works:
- (a) when the trenches have been excavated and the pipes laid to true line and level.
  - (b) when using sub-soil pipes, after the calibrated metal has been placed.
  - (c) after manholes, gullies and other structures have been built and backfilling of all trenches completed.
- 1.2.4 A minimum of two working days notice is required so that an inspection can be made prior to the next or following stage of construction being commenced.
- 1.2.5 Certification - Upon request, a certificate endorsed by the Consulting Engineer shall be submitted certifying the correctness of work in accordance with approved drawings and specifications for any of the



main stages of construction. Documentary evidence to verify quantities and/or quality of work shall be provided when requested.

- 1.2.6 Supervision - When works are in progress, the Consulting Engineer shall ensure that the Contractor has at all times a competent Supervisor stationed and present on the site of the works. A representative of the Consulting Engineer shall be available for the purpose of joint interim inspection where deemed necessary by Council's Engineer.
- 1.2.7 Testing - The Consulting Engineer shall make available to the Engineer, all test results related to the subdivisional works. Testing shall be carried out by an N.A.T.A. approved testing laboratory. Where testing of a first or preceding stage of construction is requested, then no second or following stage of work shall proceed until approval to proceed is granted by the Engineer.
- 1.2.8 In addition to the normal inspection and testing requirements as detailed elsewhere in these guidelines, the Engineer reserves the right to inspect and require samples of materials being used to be taken and tested to ascertain quantity and/or quality of materials being placed in the construction work. The Consulting Engineer will be informed of any matters requiring remedial action. In the event that such testing reveals the work to be defective, the Subdivider shall reimburse Council for the cost of the testing.
- 1.2.9 Council's Engineer will direct all notices, requests, instructions and approvals to the Consulting Engineer, except in urgent circumstances when they may be given directly to other parties involved in the subdivision.
- 1.2.10 Council is conscious of the need to preserve natural vegetation wherever possible in rural subdivisions. To this end Council may impose special conditions on particular subdivisions to minimise the environmental impact of road and drainage construction, particularly in relation to preservation of established trees within road reserves and minimising soil erosion. Subdividers should be conscious of these aims and should take them into consideration in the various stages of planning for a subdivision.
- 1.2.11 Notification of Works - The Engineer shall be advised two (2) days before commencing work, and after cessation of work, one day before recommencing any work.
- 1.2.12 Hours of work - No work outside the hours of 7.00 am to 5.00 pm Monday to Friday shall be carried out without the written approval of the Engineer.

- 1.2.13 Indemnity Insurance - The Subdivider shall be responsible for arranging, taking out and keeping in operation all necessary insurance policies to totally indemnify and protect the Council against any and all claims of damages or other claims that may arise during the carrying out of the construction work.

### **1.3 Practical Completion Of Subdivisional Works**

- 1.3.1 Upon the satisfactory completion of all subdivisional work including survey, lot pegging and soil stabilisation, the Consulting Engineer shall notify Council in writing that the works have been inspected and are in accordance with the approved drawings and/or specifications.
- 1.3.2 Upon receipt of this notification, the Engineer shall arrange a Practical Completion inspection of the completed works. Any such inspection shall require the presence of the Engineer and the Consulting Engineer.
- 1.3.3 At the time of the Practical Completion inspection or as soon as possible thereafter, the Engineer shall inform the Consulting Engineer of any item/s not in accordance with the drawings and specifications. Any such item/s so indicated shall be rectified without delay and a further inspection of these works shall be carried out upon completion of these remedial works.
- 1.3.3 If at any time after the granting of Practical Completion, the subdivisional work is found to be contrary to the approved drawings, then the Subdivider shall rectify the works at no expense to Council.

### **1.4 Survey Release**

- 1.4.1 The Consulting Engineer shall satisfy Council that the Subdivider has complied with all relevant conditions imposed by the Department of Planning and Infrastructure's Conditions of Approval of Subdivision pertaining to survey release of all or part of the subdivision.
- 1.4.2 The following items refer to the conditions which must be completed by the Subdivider prior to the approval of survey release for the subdivision.
- (i) Diagram of survey showing full details of all lots, road reserves, easements (temporary and permanent) and reserves.
  - (ii) Payment of monies for construction of paths as required by Section 2.4.
  - (iii) Payment of appropriate supervision fee as required by Clause 1.1.5.
  - (iv) Receipt of the Consulting Engineer's Certificate as required by Clause 1.3.1.

- (v) Completion of all works associated with the subdivisional construction or the payment of appropriate bond to cover outstanding works as required by Section 1.5.
- (vi) Payment of Maintenance Retention Bond as required by Section 1.6.
- (vii) Provision of "As Constructed" drawings as required by Section 3.5.5.

## 1.5 Bonding Outstanding Works

1.5.1 Council may accept payment from the Subdivider by way of a bond in the form of cash or bank cheque from a financial institution acceptable to Council in lieu of completion of part of the subdivisional works. Such bonds will be placed in a non-interest bearing account.

1.5.2 Applications for bonding shall be in writing from the Consulting Engineer to Council and shall include the following information:

- (i) Concise reference to the extent, nature and location of the work to be bonded.
- (ii) A timetable for proposed future completion of the bonded work.
- (iii) An itemised estimate of the bonded work including contract price and name and address of the Contractors responsible for the bonded works.
- (iv) Reasons for requesting the bonding of the incomplete works.
- (v) Any other relevant information, which will assist Council in assessing the request.

Compliance with the above requirements does not necessarily imply Council acceptance of the bond and each request shall be subject to Council's approval.

1.5.3 In cases where bonding is approved, the Subdivider shall enter into a written bond agreement with the Council which clearly states the following information:

- (i) Name and address of the person or persons responsible for the payment or payments.
- (ii) The amount of the payment or payments.
- (iii) Name, staging number and location of the associated subdivision.
- (iv) The Western Australian Planning Commission reference number of the associated subdivision.
- (v) A concise explanation of the purpose and conditions of payment referring to all items for which the bond payment is to be utilised.

1.5.4 The earliest stage that bonding will be considered is upon completion of all filling, drainage and roads to sub-base stage. In this event, the value of the bond shall be 50% of the total contract value for the roads, drainage and filling works.

1.5.5 Bonding will be considered at any stage later than that specified in the preceding clause in which case the value of the bond shall be twice the estimated cost of the uncompleted works or \$2,000 whichever is the greater.

1.5.6 Upon completion of the works described in the Bond Agreement, the Subdivider shall request in writing the release of the bond, following which the works will be inspected and, subject to all outstanding works being completed, the bond monies will be refunded.

## 1.6 Maintenance

### 1.6.1 Maintenance Liability

1.6.1.1 It shall be the responsibility of the Subdivider to maintain all roads and associated works for a period of two years from the date of Practical Completion hereinafter referred to as the Maintenance Period. Where defects requiring urgent attention become evident during the Maintenance Period, Council may request these works to be rectified immediately. Failure to complete the rectification works within the time specified will cause Council to carry out the works using monies from the Maintenance Bond.

1.6.1.2 At the expiry of the Maintenance Period the Consulting Engineer shall inform the Council of his intention to inspect the subdivision, and at a time mutually agreeable to all parties, such an inspection shall be made.

1.6.1.3 The Consulting Engineer shall apply in writing to Council for Maintenance Release, which will be subject to the satisfactory repair of defective works, cleaning of the drainage system and the sweeping of the roads, and the Council's acceptance of such works.

1.6.1.4 Where a Subdivider chooses to delay seeking subdivisional clearance after the date of Practical Completion, the Council may redefine the date of commencement of the Maintenance Period as being the date of subdivisional clearance.

### 1.6.2 Maintenance Bond

Prior to the release of the subdivision, the Subdivider shall pay to the Council a Maintenance Retention Bond equivalent to two and a half percent of the value of the road and drainage contract, with a minimum of \$2,000. This payment must be in the form of cash or bank cheque from a financial institution acceptable to Council and may be used at the discretion of Council during the

Maintenance Period for minor or urgent maintenance items after having notified the Consulting Engineer in writing of the need for such works. Such bonds will be placed in a non-interest bearing account and, upon the Council's acceptance of Maintenance Release, all unspent bond monies will be refunded.



## SECTION 2 – DESIGN PRINCIPLES

## 2. DESIGN CRITERIA

### 2.1 General

Criteria provided here are minimum criteria only and are necessarily broad based to cover general subdivision situations. In particular situations amendments may be required and Council may impose special conditions not covered by the criteria. It is the developers responsibility to source and adhere to the relevant standards.

### 2.2 Roads

#### 2.2.1 General

Roads should generally be designed in accordance with relevant Austroads (NAASRA) and ARRB guidelines and publications, which include:  
Guide to Traffic Engineering Practice

- (i) Guide for the Design of Typical Urban Intersections
- (ii) Guide Policy for Geometric Design of Major Urban Roads
- (iii) Policy for Geometric Design of Rural Roads
- (iv) Policy for Installation by Public Utility Authorities within the Road Reserve
- (v) A Structural Design Guide for Flexible Residential Street Pavements
- (vi) Pavement Design – A guide to the Structural Design of Road Pavements.
- (vii) Australian Model Code for Residential Development
- (viii) Bicycle Facilities Design Guidelines
- (ix) Where there is any conflict between the requirements of these guidelines and the above publications, the details specified in these guidelines

Generally all road pavement widths shall conform to the Shire of Nannup road hierarchy, which enables the safe and orderly movement of vehicles, cyclists and pedestrians within and throughout the municipality. Consideration however must be given to the final aesthetic and functional aspects of the area, particularly in rural areas. Aspects to be considered include minimising the environmental impact (particularly regarding existing trees and vegetation), fitting road

grades as close to existing contours as practicable and provision of lot access.



### 2.2.2 Pavement Design

Pavements shall generally be designed for a 40 year design life in accordance with the publication "Pavement Design" NAASRA 1987 (or its latest issue).

In all cases pavement design shall be based on the in situ subgrade California Bearing Ratio (CBR), which shall be determined for each different subgrade type expected to be encountered in the works. Determination of subgrade CBR shall be by one of the methods nominated in the publication "Pavement Design", i.e. by laboratory testing, or by field testing backed up by limited laboratory tests. The Consultant shall adopt whatever test procedures are necessary to provide an accurate assessment of subgrade CBR for design purposes. Council's Engineer may request further field or laboratory testing at his discretion.

In any case the absolute minimum pavement profile shall be as follows:

	Alternative 1	Alternative 2
Access Roads & Collector Roads	125 "B" grade sub-base course 100 "A" grade base course 25mm asphalt on urban roads Two coat sprayed seal on rural roads. Asphalt on all intersections	200 "A" grade base course 25mm asphalt on urban roads Two coat sprayed seal on rural roads. Asphalt on all intersections
Other Roads (except industrial)	150 "B" grade sub-base course 100 "A" grade base course 25mm asphalt on urban roads Two coat sprayed seal on rural roads. Asphalt on all intersections	225 "A" grade base course 25mm asphalt on urban roads Two coat sprayed seal on rural roads. Asphalt on all intersections
Industrial roads	175 "B" grade sub-base course 100 "A" grade base course 40mm asphalt	250 "A" grade base course 40mm asphalt

Alternative pavement profiles giving equivalent load bearing capacities will be considered. Council may, at its discretion, allow sprayed seal surfacing in lieu of asphalt surfacing on urban roads.

### 2.2.3 Materials

#### 2.2.3.1 "A" Grade Base course

"A" grade base course shall consist of graded crushed rock or laterite gravel. When tested in accordance with AS 1289 the material shall have the following properties:

As Sieve Aperture (mm)	Percentage Passing
26.5	100
19.0	95-100
9.5	70-88
4.75	48-71
2.36	34-57
1.18	24-46
0.425	14-33
0.075	6-20

Liquid Limit:	not to exceed 25%
Plasticity Index:	not to exceed 6%
Linear Shrinkage:	not to exceed 2%
Los Angeles Abrasion Value:	not to exceed 40%
Maximum Dry Comp. Strength:	not less than 1700 kPa

The material shall be free from organic matter and other deleterious substances.

#### 2.2.3.2 "B" Grade Sub-Base course

"B" grade sub-base course shall consist of limestone or lateritic gravel.

Limestone and lateritic gravel shall be in accordance with Council's Specification for such materials, which in summary includes:

**Limestone** shall conform to the following requirements:

- all materials shall contain a maximum of 70% calcium carbonate;
- all material shall pass through a 100mm square sieve;
- not more than 80% of the material shall pass through a 2.36 AS sieve;
- not more than 15% of the material shall pass through a 75 micron AS Sieve;
- all material shall be free from capstone, roots and other deleterious substances.

**Gravel** shall be selected natural laterite gravel which exhibits an even grading curve throughout the full range. When tested to AS 1289 the material shall have the following properties:

- Percentage passing 40mm sieve: 100%
- Percentage passing 1.18mm sieve: 10% to 50%
- Percentage passing 0.075mm sieve: less than 20%

- Plasticity Index: 3% to 10%
- Linear Shrinkage: less than 8%
- Minimum CBR at the placed  
in situ moisture density condition: 35

The material shall be free from organic matter and other deleterious substances.

It is preferable for crushed gravel (Ferricrete or similar) to be used for the base course.

#### 2.2.3.3 Asphalt

Asphalt shall be a nominal 10mm size asphaltic concrete mix in accordance with an AC10 mix designation to AS 2734.

#### 2.2.3.4 Sprayed seals

Sprayed seals shall consist of a minimum two coat seal. The first or primer seal shall be a hot sprayed bitumen primer seal, unless, with the approval of the Engineer, a bitumen emulsion primer seal may be used.

In rural residential areas, the cover aggregates shall be 10mm granite, followed by the second coat of 10mm diorite metal.

In areas zoned other than rural residential where a spray seal is applicable, the cover aggregate shall be 5mm granite and 14mm diorite metal respectively.

#### 2.2.4 Base course Widths

On kerbed roads the width of base course shall equal the width of seal plus 900mm. On uncurbed roads the width of base course shall equal the width of seal plus 1.3 metre shoulders.

#### 2.2.5 Shoulders

Shoulders shall be constructed with the same materials and to the same depth as the adjacent base course.

#### 2.2.6 Road Reserve Width

Local roads shall have a minimum road reserve width of 20 metres, however, Council reserves the right to make a wider road reserve should the site or engineering requirements dictate.

The designation of which road types shall apply to a particular subdivision (i.e. town centre residential, rural, rural living or mixed business) shall be in accordance with the Shire of Nannup Zoning Scheme.

### 2.2.7 Town Centre and Residential Streets

Road design guidelines may generally be in accordance with Department of Planning and Infrastructure Policy DC 2.6 including:

Local Distributors: 7.4 m wide, concrete kerbed with 25mm asphalt surface on a primer seal.

Access Road: 7.0m wide, concrete kerbed with 25mm asphalt surface on a primer seal.

The maximum longitudinal grade of a road shall be 10% (1 in 10) unless otherwise approved

The minimum longitudinal grade shall be 0.50% or 1 in 200, however because of water shedding problems, this grade should only be used in extreme circumstances.

All changes of grade of more than 1% shall be joined by a vertical curve. The length of all vertical curves shall be in accordance with the relevant Austroads publications, and shall take into account overtaking and stopping sight distances and comfort factors.

The cross fall on the cross section of the road pavement shall be generally 3% each way from the crown but through horizontal curves, one way cross fall or superelevation shall be applied in accordance with the appropriate Austroads guidelines. In minor residential streets and cul-de-sacs the road pavement may have a one-way cross fall where the natural surface across the road reserve lends itself to this type of construction. This condition does not apply on horizontal curves where the normal requirement of superelevation to match design speeds and radii shall apply.

Verges shall have sufficient width for the provision of public utility services, and shall be a minimum of 3.5m. Verges shall normally be graded at +2% from the top of the kerb to the property boundary. In areas of steep cross fall or where earthworks should desirably be reduced to minimise environmental impact, the verge grading may be increased as agreed with Council's Engineer.

Culs-de-sac shall have a minimum head radius of 9m with 15m radius tapers.

Kerb type shall be mountable to residential frontages and semi-barrier elsewhere.

The Consulting Engineer shall prepare detailed designs of the pavement thicknesses in accordance with Australian Road Research Board (A.R.R.B.) and/or Austroads Design Guidelines as follows:

- “Pavement Design – A Guide to the Structural Design of Road Pavements”, Austroads, 1987.
- “A Structural Design Guide for Flexible Residential Street Pavements”, P.J. Mulholland, ARRB Special Report No 41.

Notwithstanding the design thicknesses obtained, the sub-base course shall be a minimum compacted thickness of 150 mm, the base course shall be a minimum compacted thickness of 75 mm and the asphalt compacted thickness shall be a minimum of 25mm.

The designer shall provide pavement drainage where necessary to maintain a moisture-free subgrade and base course as determined by the site conditions.

The road base shall extend 500 mm beyond the face of kerb.

#### 2.2.8 Rural Living Streets

The minimum standard for rural living streets within a subdivision shall be as follows:

Straight Pavements: 7 metre wide, two coat seal (2x10mm stone) with 1.2 metre shoulders, 1 coat seal (10mm stone)

Intersections:

- (a) All intersections shall be provided with concrete kerbing to at least 10 metres beyond the tangent point of the sweep. This kerbing shall repeat on the opposite side of the intersection on the straight section of road. At the terminating end, the kerbing shall be flared towards the verge.
- (b) All intersections shall be provided with a 25mm asphalt surface on a primer seal, to the full extent of the concrete kerbing.

Geometric design shall be according to ‘Rural Road Design’, Austroads 1989. The maximum design speed for access roads shall be 60 km/hr, collector roads 70 km/hr and arterial roads 90 km/hr. These design speeds shall be verified by Main Roads Western Australia.

The maximum longitudinal grade of a road shall be 12.5% unless otherwise approved. The minimum longitudinal grade shall be 0.5% unless table drains are graded independently of the road to provide satisfactory drainage.

All changes of grade of more than 1% shall be joined by a vertical curve. The length of all vertical curves shall be in accordance with the relevant Austroads publications, and shall take into account overtaking and stopping sight distances and comfort factors.

One-way cross fall to a maximum of 3% may be approved for access roads when excessive cross fall exists in the natural surface. Roads shall normally have two-way cross-falls of 3% except where geometric design requirements dictate that superelevation is required.

Table drains shall be provided for all roads for a minimum width of 1.2m, flat bottomed, with side slopes of a minimum 1:3 grade (33%).

Cut batters shall generally be no steeper than 1 in 3 (33%) except in hilly terrain, where depth of cut is considerable, or where ground conditions are such that it is not practical to comply with this requirement without excessive cost or environmental disturbance. Subject to the approval of Council's Engineer, cut batters may be increased to a maximum of 1 in 1 (100%). Fill batters shall generally be no steeper than 1 in 4 (25%) except in hilly terrain or where fill heights are considerable, in which case a maximum slope of 1 in 2 (50%) may be used subject to the approval of Council's Engineer.

Verges shall have sufficient width to install public utility services. In particular sufficient width must be provided to install overhead power lines with poles located at least 2.5m from the invert of the table drain.

Roads shall be designed to enable access to lots at an absolute maximum grade of 16%.

Cul-de-sac heads shall have a minimum head radius of 9m to edge of seal, with 15m radius tapers.

### 2.2.9 Rural Roads

Rural roads shall comply with the standards prescribed in the Roads 2020 Strategy, and will be dependent on estimated AADT counts.

Council has identified minimum road standards, given known and/or estimated Annual Average Daily Traffic (AADT) counts.

Type 1	Formed road constructed from surrounding local material: 10-20 AADT – 6m unsealed pavement with 1.5m shoulders.
Type 2	Formed road paved with imported gravel material: 20-75 AADT – 6m unsealed pavement with 1.5m shoulders.
Type 3	Sealed road (6m seal width + shoulders): 75-500 AADT.
Type 4	Sealed road (7m seal width + shoulders): 500-1000 AADT.
Type 5	Sealed road (8-9m seal width + shoulders): 1000-4000 AADT.

Type 6 Sealed road with overtaking lanes: 2000+ AADT but lower volumes may be considered depending on the percentage of heavy vehicles and terrain conditions.

Type 7 Dual carriageway – divided rural road: 4500 +AADT.

For the purposes of determining the impact a subdivision will have on AADT counts for any particular road, Council will utilise eight vehicle movements per lot per day.

All rural roads shall be sealed with a two coat seal (2x10mm stone) with 1.3 metre shoulders sealed with a 1 coat seal (10mm stone), except at intersections which shall be kerbed with 25mm asphalt over a primer seal. The extent of the kerbing shall be as stipulated for “Rural Living Streets”.

Where existing rural roads are considered by Council to warrant sealing, the width of such sealing shall be a minimum of 7.0 metres, the maximum width being determined on the basis of AADT counts.

The maximum longitudinal grade of a road shall be 8% unless otherwise approved. The minimum longitudinal grade shall be 0.5%.

All changes of grade of more than 1% shall be joined by a vertical curve. The length of all vertical curves shall be in accordance with the relevant Austroads publications, and shall take into account overtaking and stopping sight distances and comfort factors.

Intersections of arterial roads shall be widened as follows:

- Terminating road (collector or access) shall be widened to at least 7.4 m seal width for a straight length of 10m from the tangent point of the turn-out radius, and then tapering to the normal seal width over an additional 10m length;
- Through road (arterial) shall be widened on the approach near side by a 2.5m deceleration lane, with a minimum 1.3m wide shoulder, for a distance of at least 30m from the tangent point of the turn out radius, and then tapered back to the normal seal width over an additional 10m length.
- On the departure near side, it shall be widened by at least 1m from the tangent point of the turn out radius for a length of at least 10m (which shall be kerbed).
- On the opposite side of the road, it shall be widened by a 2.5m passing lane for a distance of 45m either side of the centre line of the intersecting road, and then tapered back to the normal seal width over an additional 100m at each end.

Verges shall have sufficient width for the provision of public utility services, and shall be a minimum of 3.5m. In areas of steep crossfall or where

earthworks should desirably be reduced to minimise environmental impact, the verge grading may be increased as agreed with Council's Engineer.

The maximum longitudinal grade of a road shall be 12.5% unless otherwise approved. The minimum longitudinal grade shall be 0.5% unless table drains are graded independently of the road to provide satisfactory drainage, where necessary. A vertical curve shall be provided when the grade change is 1% or greater.

Geometric design shall be according to 'Rural Road Design', Austroads 1989. The design speed for any rural road shall be determined by Main Roads Western Australia.

One-way cross fall to a maximum of 3% may be approved for access roads when excessive cross fall exists in the natural surface. Roads shall normally have two-way cross-falls of 3% except where geometric design requirements dictate that superelevation is required.

Table drains shall be provided for all roads for a minimum width of 1.2m, flat bottomed, with side slopes of a minimum 1:3 grade (33%).

Cut batters shall generally be no steeper than 1 in 3 (33%) except in hilly terrain, or where depth of cut is considerable, or where ground conditions are such that it is not practical to comply with this requirement without excessive cost or environmental disturbance. Then, subject to the approval of Council's Engineer, cut batters may be increased to a maximum of 1 in 1 (100%). Fill batters shall generally be no steeper than 1 in 4 (25%) except in hilly terrain or where fill heights are considerable, in which case a maximum slope of 1 in 2 (50%) may be used subject to the approval of Council's Engineer.

Traffic control devices, sign posts, guide posts, street nameplates, guide signs and warning signs shall be provided in accordance with AS1742 to the satisfaction of Council's Engineer.

#### 2.2.10 Industrial Roads

In light industrial areas, roads shall be kerbed and sealed (25mm asphalt) to a minimum width of 7.4 m. All other design criteria shall be in accordance with the requirements for Urban Residential Streets with the following exceptions:

- Verge width to be a minimum 4.5m;
- Culs-de-sac shall be avoided wherever possible;
- Kerbs shall be semi-mountable.

In heavy industrial areas, road construction requirements will be subject to specific engineering design.



Where culs-de-sac cannot be avoided, they shall have a minimum head radius of 15m with 25m radius tapers.

#### 2.2.11 Public Utility Conduits

The Consultant shall ascertain the need for conduits under roads for all public utility services for both present and future services. If the public utility authority concerned will not install conduits at the time of construction of the roads, then the conduits shall be installed by the Subdivider (prior to surfacing of roads) whether or not the conduits are immediately required. Backfill trenches for conduits with compacted cement stabilised sand as detailed for storm water pipeline systems in Section 2.8.6.

### 2.3 Stormwater Drainage

#### 2.3.1 General

Stormwater drainage systems are required to provide for effective disposal of stormwater and all drainage designs shall comply with appropriate industry design standards such as:

- “Australian Rainfall and Runoff” Institution of Engineers, Australia.
- “Stormwater Drainage Design in Small Urban Catchments” J Argue, ARRB Special Report No 34.
- “Subsurface Drainage of Road Structures” R J Gerke, ARRB Special Report No 35. All piped drainage lines shall be designed in accordance with the pipe manufacturer’s recommendations and appropriate Australian Standards.

2.3.2 All drainage systems shall be piped in urban and residential areas and open drains and swales in rural areas unless otherwise approved. The designer shall design the drainage network using a recurrence interval of 5 years except in the case of arterial drains and compensating basins where a recurrence interval of 10 years shall be used. Additionally, the designer shall provide for the adequate discharge of flood flows between the intervals mentioned above and a 100 year recurrence interval in order that the floor level of all buildings shall be 500 mm above the 100-year flood level.

2.3.3 It is possible that some existing drainage systems in the municipality may not be able to carry the design storms applicable to the recurrence intervals detailed in the preceding Clause. It is the responsibility of the Consulting Engineer to examine the complete downstream network to evaluate the maximum quantity of water, which may be discharged into the existing network. If, using the recurrence intervals mentioned above, the capacity of the existing drainage network is exceeded, the Council Engineers may direct that the surplus water either be retained within the subdivision in an approved manner or the existing drainage system upgraded to accommodate the design run-off.

2.3.4 It shall be the responsibility of the Consulting Engineer to examine the total catchment area of which a particular subdivision may form a part, and to ensure that any arterial drainage that may pass through the particular subdivision is capable of carrying the ultimate design flow from the upstream catchment. Subdividers are responsible for arranging their own cost sharing arrangements, however, in some instances Council may administer such arrangements at the Subdivider's request.

2.3.5 In cases where stormwater is discharged onto private land downstream of a subdivision or development, arrangements shall be made by the Subdivider with the owner of the downstream land to provide an easement in favour of Council over the route of the drain and to construct and/or improve the drainage outlet to the requirements of Council's Engineer.

2.3.6 The subdivisional drainage system shall be connected to an approved outlet in the district drainage system by a suitable outfall drain as approved.

#### 2.3.7 Types Of Pipework

The following pipe types shall be permitted:

Residential areas: reinforced concrete pipes (and boxes) in classes appropriate to loadings and cover heights;  
aluminium Hel-Cor pipes with a minimum cover of 600mm;  
PVC pipes in classes appropriate to loadings and cover heights.

Rural Areas: reinforced concrete pipes (and boxes) in classes appropriate to loadings and cover heights;  
steel and aluminium Hel-Cor pipes with a minimum cover of 600mm.

Other types of pipes shall be approved by Council's Engineer.

The minimum pipe size in the verge or within private property shall be 225mm diameter and the minimum pipe size under roads shall be 300mm diameter.

Pipelines shall be designed to ensure that hydraulic grade lines do not reach a level of less than 150mm from finished surface levels for the design recurrence interval.

The velocity in pipes shall be limited to the range 1.0 m/sec - 6.0 m/sec. The possibility of scour at outfalls shall be considered and steps taken to eliminate it where it may occur.

Manholes shall be provided at each change in direction and at a maximum spacing of 90 metres.

Inlet pits shall be placed at low points and at the upstream side of intersections if warranted by flow considerations. Inlet pits shall also be placed at intervals to limit the width of gutter flow to 1.5m (or 2.0m in the case of one-way crossfall), in kerbed roads, and at intervals to prevent the top water level in the table drain from rising to within 200mm of the edge of the shoulder in the case of un-kerbed roads, or to limit the inflow to the entry pit to its inlet capacity, whichever is the least, for the design recurrence interval flows.

On kerbed roads side entry pits shall be used wherever possible, although combined side entry/grated pits may also be used.

On un-kerbed roads, any concrete catchpits situated in table drains shall have grated tops at least 150mm above entry lips to prevent access to the pit by the public.

All outlets to pipe drainage systems (and inlets in the case of open ended culverts) shall have concrete headwalls with concrete aprons, and shall have anti-scour rock beaching for a minimum distance of 2m beyond the edge of aprons.

All trenches for pipes laid under road pavements shall be backfilled to the pavement subgrade surface with compacted cement stabilised sand or road base course material. Sand and cement shall be thoroughly mixed in the proportions of 100kg of cement to one cubic metre of sand. Sufficient water shall be added and mixed such that the moisture content is just sufficient to enable mixing and placement of the material. The material shall be placed in even layers not exceeding 225mm in thickness and each layer shall be compacted with a minimum of four (4) passes of a vibratory plate compactor having a minimum static mass of 50kg.

Care shall be taken to ensure that the material fills all voids under the haunches and that no damage occurs to the pipe whilst compacting material next to and immediately over the pipe.

The cement stabilised sand shall preferably be supplied from a central batch mixing plant.

### 2.3.8 Open Drains

Where drainage is by means of open drains, allowances must be made for access culverts to properties which must be provided at the development stage by the Subdivider.

All culverts shall have adequate concrete headwalls and drain scour protection. Where pre-cast headwalls are used, the finished level of the headwall shall not project more than 100mm above the adjacent pavement level.

Table drains to un-kerbed roads shall be sized so that the top water level in a drain does not rise to within 200mm of the edge of the shoulder for the design recurrence interval flow. Installation of catchpits is at the discretion of Council's Engineer. Culverts may be utilised to contain flows in table drains within permissible limits where practicable.

Where there is a risk of scouring in open drains (including table drains), the drains shall be fully lined with a lining of rock, concrete or other method approved by Council's Engineer.

### 2.3.9 Sub-Soil Drains

Where sub-soil water is present, or is likely to become present at any time, and is likely to interfere with the stability of any buildings, the road pavement (or footpath or accessway, etc) a system of sub-soil drainage shall be designed and installed to the approval of Council's Engineer.

Sub-soil drains shall be installed to cut off flows at least 600mm clear of any building or surface of the pavement and shall discharge to piped drainage systems or open drains downstream of the affected area, as appropriate for each situation.

### 2.3.10 Drainage Easements

Where drains are laid within, or discharge stormwater onto private property the drain and stormwater discharge shall be protected by registered easements which shall show on all plans. The easement shall be centrally located over and about the drainage line and it shall have a width of at least twice the depth of the drain with an absolute minimum width of 3.0m.

## 2.4 Miscellaneous Facilities

### 2.4.1 Pathways

Pathways in road reserves shall be provided in urban residential subdivisions unless special circumstances prevail in which case they may be omitted at Council's discretion. If pathways are required they shall be provided at the Subdivider's cost. Council may wish to defer construction of such paths until

the majority of houses fronting the street are constructed to enable driveway crossings to be located and constructed. In this case the Subdivider shall pay to Council the estimated cost of the deferred pathways (as estimated by Council) in lieu of constructing the paths at the time of subdivision.

Where paths are to be provided by the Subdivider they shall normally be 2.0m dual-use x 100mm thick concrete paths with a 2% slope towards kerbs (or edge of roadways). Tooled lock-joint contraction joints shall be provided at 2m intervals and 12mm wide full depth expansion joints shall be provided at 6m intervals. The surfaces of concrete paths shall have a non-slip broomed finish. Alternatively Council may accept asphalt surfaced paths in lieu of concrete paths in special situations. Asphalt paths shall consist of 20mm thick size 7 asphalt on 75mm thick "A" grade compacted base course. Other types of path may be accepted at Council's discretion.

Pathways shall generally be provided on both sides of a road and shall be laid parallel to the kerb line (or edge of roadway). The longitudinal profile shall follow the longitudinal profile of the kerb line (or edge of roadway).

All pathways shall be illuminated with appropriate lighting.

#### 2.4.2 Signs and Guide Posts

All direction or warning signs and guide posts shall be erected in accordance with AS 1742.5 - 1986. Requirements for such signs shall be clearly shown on the drawings.

#### 2.4.3 Street Nameplates

Street nameplates shall be erected at all newly created intersections and shall indicate the names of both streets. Nameplates shall generally be in accordance with AS 1742.5 - 1986 and shall incorporate any special feature which may be required by Council (eg Shire logo, colours of legend and background, etc).

Depth of sign shall be 150mm with 100mm lettering except on major roads where a depth of 200mm with 150mm lettering shall be used.

Signs shall be mounted at a height of three (3) metres above finished ground level. If two or more signs are to be erected on the same pole they shall be erected at differing levels.

Nameplates shall be mounted on a 50mm nom. bore galvanised steel pole concreted a minimum of 600mm into the ground. The pole shall be erected where possible on the 2.7m alignment.

#### 2.4.4 Battle-Axe Block Access Roads

Access road pavement to battle-axe blocks shall not be less than three metres wide and centrally located for the full length of the access way. Special consideration shall be given to “reciprocal rights” access ways which will require greater road pavement width.

The design, shape, width, sealing and drainage of these access ways shall be to the approval of Council.

#### 2.4.5 Standard Crossovers

Crossovers, constructed to Council’s standard, shall be constructed to all new lots. The location of such crossovers shall be to Council’s satisfaction.

Crossovers shall be constructed to a minimum width of 2.7m, using either 100mm concrete, or approved interlocking brick paving. Culvert pipes beneath crossovers shall be a minimum 300cm diameter RCP and 4.8m in length. Headwalls to culverts shall be of concrete construction.



## SECTION 3 – DRAWINGS

### 3. REQUIREMENTS FOR DRAWINGS

#### 3.1 General

- 3.1.1 Two copies of the initial design drawings, specifications and drainage and pavement calculations shall be submitted for approval by Council.
- 3.1.2 Any amendments will be marked up on one copy which shall be returned to the Consultant. Three copies of amended drawings and specifications shall then be re-submitted by the Consultant. One copy of approved drawings and specifications shall be signed by Council's Engineer and marked "Approved for Construction" and shall be returned to the Consultant together with any conditions imposed on the approval.
- 3.1.3 No construction shall commence until "approved for construction" drawings are certified by Council's Consulting Engineer.

#### 3.2 Drainage Calculations

Submit drainage calculations for approval for every underground drain and all open drains (except table drains) including bridges, pipe drains, box culvert drains, etc. Calculations shall show catchment areas, run-off coefficients, recurrence intervals, rainfall intensities, times of concentration and method of sizing of drains. Calculations shall be set out in a standard tabular format or approved format to facilitate checking.

#### 3.3 Pavement Calculations

Submit pavement calculations for approval. Calculations shall show the method adopted for calculation of subgrade CBR including test results, design pavement life, design traffic loadings, determination of base course thicknesses and need for subgrade stabilisation/improvement where necessary. Provide copies of all subgrade tests.

#### 3.4 Required Drawing Scales

Scales of plans where possible should conform to the following:

- |     |   |  |
|-----|---|--|
| (a) | Overall Layout Plan   | 1/500 or 1/1000                        |
| (b) | Plan  | 1/500                                  |
| (c) | Longitudinal Section  | 1/500 horizontally<br>1/50 vertically  |
| (d) | Cross Sections  | 1/200 horizontally<br>1/100 vertically |
| (e) | Particular Details<br>(intersections, culs de-sac, turn circles, traffic devices) | 1/200 or 1/250                         |



These scales are minimal and may be increased on jobs of small extent.

The datum used shall be an established Department of Land Administration Bench Mark to Australian Height Datum. The location of such datum points shall be clearly indicated on the plan.

### 3.5 Drawing Information

#### 3.5.1 Layout Plan

Layout Plan shall show:

- (a) all existing and new streets and roads with the allocated street names
- (b) all lots fronting such streets with each lot numbered and fully dimensioned
- (c) all existing and proposed street drainage, allotment drains with necessary easements and outfall drains
- (d) all survey and bench marks
- (e) all existing and proposed contours
- (f) the north point
- (g) all proposed traffic management devices.

#### 3.5.2 Road Plans

Each street shall be drawn in plan and profile.

The plan of the street shall show:

- (a) width of all pavements, verges and medians
- (b) design speed of the road
- (c) distances on the centre line of the road (SKL)
- (d) all horizontal curve data
- (e) all existing and proposed contours
- (f) all existing and proposed street drainage including manholes and gullies
- (g) all lots facing onto the street
- (h) all traffic management devices
- (i) all existing and proposed services in the road reserve
- (j) north point.

The longitudinal profile of the road shall show:

- (a) a running distance along the centre line of the road (SKL)
- (b) the natural surface levels along the centre line and both property lines
- (c) design levels at the centre line and both channels. These levels shall be at 20 metre intervals on straight grades and alignments and at 10 metre intervals on vertical and horizontal curves
- (d) lengths of grade lines with grades expressed as a percentage
- (e) intersection and tangent points at change of grades

- (f) length of vertical curves
- (g) transition and superelevation details
- (h) finished surface levels along both property lines

Cross section details shall be provided in all cases to show the thicknesses and other relevant details.

Intersections, cul-de-sac heads, roundabouts and any other traffic device or feature – details of these devices shall include:

- (a) all lot boundaries
- (b) geometric details
- (c) design levels at appropriate points
- (d) all services, including drainage
- (e) north point.

### 3.5.3 Drainage Plans

All drainage lines will be drawn in plan and profile on the same drawing at the scales as previously specified.

The plan shall show:

- (a) all existing and proposed drainage lines showing pipe sizes, grades, lengths, manholes, gullies, other drainage structures and whether the pipes are solid or slotted
- (b) upstream and downstream levels on all existing drainage outfalls to which connections are being made
- (c) all existing and proposed sewer lines and any other services which may effect
- (d) all existing and proposed contours and spot levels
- (e) where appropriate and especially on industrial subdivisions, the stormwater connection location and the designed discharge from each lot.
- (f) the north point
- (g) all drainage easements including their description and width
- (h) all streets with their allocated names and all lots facing onto such streets with the appropriate lot number

The longitudinal section shall show:

- (a) a small plan (scale 1:2000) in the bottom right hand corner of the drawing, showing the location of the specific drains as detailed on the same drawing
- (b) all pipe sizes and grades, the class of pipe and whether the pipe is solid or slotted
- (c) the existing natural and finished surface levels
- (d) the invert levels of the pipes and the depth to invert from the finished surface level
- (e) the distances between gullies, manholes and other drainage structures.

- (f) the location and levels of all other services, especially sewer line crossings
- (g) details of all manholes, gullies and other structures.

Separate details shall be included on the drawings showing pipe laying and bedding details and other appropriate details as required.

#### 3.5.4 Earthworks Plans

In all subdivisions involving earthworks, plans showing existing and proposed contours and appropriate cross sections are required.

#### 3.5.5 "As Constructed" Drawings

The Subdivider shall submit to Council prior to the release of the subdivision, a full set of engineering drawings for the subdivisional works in reproducible form and in digital format, and certified by a licensed surveyor or other non-biased surveyors as approved as follows:

- (a) Road Drawings – amended to show details of any alterations made during construction; and
- (b) Drainage Drawings – amended to show actual lines, levels and grades against the design lines, levels and grades

and stamped "As Constructed".



## SECTION 4 – CONSTRUCTION OF ROADS

## 4. CONSTRUCTION OF ROADS AND ASSOCIATED WORKS

### 4.1 General

4.1.1 All works shall be carried out in accordance with the Occupational Health, Safety and Welfare Act, 1984.

#### 4.1.2 Temporary Road Closure

Where it is necessary to close an existing road to carry out any part of the subdivisional works, approval for such closure shall be obtained from the Engineer at least (28) days prior to the work commencing.

The following conditions shall apply to such closures:

- (a) A suitable detour shall be determined and clearly signposted with approved signs for the duration of the works and if no such detour is available, suitable and passable side tracks shall be provided.
- (b) In the case of arterial roads and on other roads where a suitable and convenient detour is unavailable, the road closure shall be advertised by double column display advertisements in local newspapers advising the reason, location and duration of the closure and the route of the proposed detour, such advertisements being placed 21 days prior to the date of the proposed closure.
- (c) In the case of arterial roads and on other roads where a suitable and convenient detour is unavailable, advisory signs shall be erected at appropriate locations on the site 21 days prior to the closure, such signs to comprise a minimum 100 mm letter height and to advise the reason, location and duration of the road closure.
- (d) The works and road closure shall be adequately lit at night and other appropriate precautions shall be taken to ensure public safety.
- (e) Emergency services, schools, other large institutions and large businesses that may be affected by the closure shall be advised in writing of the reason, location and duration of the road closure and the route of the proposed detour at least 21 days prior to the closure.
- (f) The works shall be carried out in an expeditious manner to minimise the impact of the road closure on the general public.
- (g) Where the road closure is required by a private contractor to carry out works in the road reserve then the contractor must obtain approval from Council's Engineers prior to commencing the works.

### 4.2 Survey Set Out

4.2.1 All works shall be set out and constructed in accordance with the alignments, levels, grades and cross sections as shown in the approved drawings.

4.2.2 Care shall be taken when working in the vicinity of survey pegs and bench marks to ensure the accuracy thereof.

4.2.3 The Subdivider shall be responsible for the accuracy of the setting out of works.

#### 4.3 Construction Tolerances

The tolerances to levels permitted for the various stages of road construction shall be as follows:

Sub-grade	-50mm to + 0mm
Sub-base	-25mm to +10 mm
Base	-10mm to +10 mm
Bitumen primer	+/- 0.5 litres/m <sup>2</sup>
Concrete kerbing	Refer to Clause 4.12
Asphalt surfacing	+/- 5mm

#### 4.4 Clearing Works

4.4.1 Clearing of all shrubs and trees shall be completed to an extent sufficient to facilitate the construction work. Natural vegetation should be retained where possible.

4.4.2 All tree roots, boulders and other deleterious material shall, where possible, be totally removed to a depth of 600 mm below the natural surface or finished surface levels of the street, whichever is the greater. Stumps shall be completely removed.

4.4.3 All holes and depressions resulting from clearing and grubbing shall be backfilled with approved material and compacted to at least the compaction of the surrounding in-situ material.

4.4.4 No material from the clearing shall be pushed beyond the limits of the site.

4.4.5 Material cleared shall be either removed from the site and disposed of at an approved waste disposal site or disposed of by burning. All burning off shall be strictly to the requirements of the Bush Fires Act and Environmental Protection Act.

## 4.5 Earthworks

- 4.5.1 Earthworks shall be completed to this specification and tolerances as set out herein and as detailed in the drawings.
- 4.5.2 The road shall be cut to the grades and batters indicated on the approved drawings.
- 4.5.3 All fill shall be clean free-draining medium to coarse sand and shall be compacted to the full depth of 95% of the modified maximum dry density when tested in accordance with AS 1289 E2.1 – 1977 unless otherwise approved.
- 4.5.4 All cut through rock shall be excavated to a depth of 100mm below sub-grade level and 200mm below the finished level of verges.

### 4.5.5 Blasting

- 4.5.5.1 Excavation in rock or hard soil may be carried out by blasting only if a blasting permit has been obtained from the Engineer in accordance with Explosives Regulations 1963 Regulation 115(6).
- 4.5.5.2 All explosives shall be stored and handled in accordance with AS2187-1983-4<sup>1</sup> under the personal supervision of the holder of a Shotfirers Permit. The shotfirer shall be held responsible for the repair, replacement, legal liability claims or anything that may arise from the blasting operations. All such screens, shields, matting and the like as is necessary to prevent rock, stones, earth, debris or other material from scattering or blowing from the immediate site of blasting shall be provided.

All road verges shall be graded evenly and smoothly, free from rubble and other deleterious material, to meet the level of the road kerb.

## 4.6 Soil Stabilisation

- 4.6.1 The subdivider shall be responsible for the satisfactory control of dust, sand drifts and waterborne erosion from the construction site including roadwork's and lots.
- 4.6.2 Stabilisation of topsoil, sand or other material or matter subject to movement over or near the subdivision shall generally be carried out in accordance with the Environmental Protection Authority's Dust Control Guidelines and to the satisfaction of the Engineer, both during

the construction stages and upon completion of the subdivisional works.

- 4.6.3 Where initial stabilisation is carried out and subsequent works associated with the subdivisional works causes deterioration of effective stabilisation of the area, the area so affected shall be re-stabilised in an appropriate manner. The Subdivider shall effect a varying method of re-stabilisation should initial stabilisations be found to be unsuitable.
- 4.6.4 Stabilisation disturbed by works other than the subdivisional works shall be the responsibility of the person responsible for the disturbance of the stabilised areas (for example, builders, private lot owners and Service Authorities).
- 4.6.5 A special performance bond in the form of cash to the value of \$0.50 per square metre of the cleared or disturbed lot area shall be lodged with the Council prior to the commencement of any works as a **condition of approval of drawings for the subdivisional works**. These monies will be used by Council to control sand drift if, in the opinion of the Engineer, the contractor is not taking adequate precautions to control the sand drift during the progress of construction work. The Consulting Engineer will be advised in writing on each occasion it becomes necessary for Council to use these monies for sand drift control. These monies will be refunded upon completion of the subdivisional works, including the stabilisation of the finished surface, less any amounts expended by Council on the control of sand drift during the construction period.
- 4.6.6 Council may reduce this bond to \$0.25 per square metre for those developments assessed in accordance with the Environmental Protection Authority's Dust Control Guidelines and where the relevant contracts for subdivisional works incorporate the dust control strategies as indicated in the guidelines.
- 4.6.7 To avoid dust nuisance to adjacent owners the Engineer may direct that **no earthworks**, including stripping, filling or placing of topsoil, be carried out when a wind is blowing towards surrounding properties which is likely to cause sand drift or dust to reach those properties.

#### 4.7 Sub-Grade

- 4.7.1 The formation shall be excavated in conformity with the profiles, dimensions, cambers and depths as shown on approved drawings.



- 4.7.2 Unless otherwise specified the width of the formation “boxed out” shall be at least 900mm greater on each side than the finished sealed width of the road pavement for urban roads.
- 4.7.3 Unless otherwise specified the width of the formation “boxed out” shall be at least 1.3m greater on each side than the finished running surface for rural roads.
- 4.7.4 The sub-grade shall be compacted to not less than 95% of its modified maximum dry density when tested in accordance with AS 1289 E2.1 – 1977 Methods of Testing Soil for Engineering Purposes.
- 4.7.5 This work shall be checked and approved prior to the placement of any foundation material.

#### **4.8 Sub-Base Course**

- 4.8.1 The sub-base shall be constructed of limestone complying with the requirements of Section 8.1 “Specification for Limestone” unless otherwise approved.
- 4.8.2 The sub-base shall be placed so that the compacted sub-grade is not disturbed and broken up and that the even thickness specified is achieved. Sub-base material shall not be spread upon a waterlogged sub-grade.
- 4.8.3 The sub-base course must be installed full depth (ie. no separate base course layers) to suit the overall pavement design.
- 4.8.4 The sub-base course shall be compacted to not less than 95% of its modified maximum dry density when tested in accordance with AS 1289 E2.1 – 1977.
- 4.8.5 Where damage to adjoining properties may result, the use of vibrating rollers will not be permitted.
- 4.8.6 All irregularities in the longitudinal grade and cross section shall be corrected in an approved manner until the road sub-base is brought to a uniformly compacted smooth and even surface.
- 4.8.7 If, during the construction period, the surface of the sub-base shows any imperfections or failures, such shall be corrected in an approved manner.
- 4.8.8 Unsatisfactory sub-base material shall be removed from the site and replaced with material as specified.

4.8.9 The sub-base construction shall be approved prior to the commencement of the placing of the base material.

#### **4.9 Base Course**

- 4.9.1 The pavement base material shall consist of fine crushed rock (road base) complying with the requirements of Section 8.2 "Specifications for Road Base" unless otherwise approved.
- 4.9.2 The base material shall be placed so that the limestone sub-base material is not disturbed or broken up during the placement of the base material and an even thickness as specified is obtained.
- 4.9.3 The base course must be installed full-depth (i.e. no separate sub-base course layers) to suit the overall pavement design as approved.
- 4.9.4 Grading of loose material over a hard surface and/or compaction in a thin layer is not permitted.
- 4.9.5 The base course shall be compacted to not less than 98% of its modified dry density when tested in accordance with AS 1289-E2.1 1977.
- 4.9.6 The base shall be water bound by the surface being sprayed with water and rolled until a slurry finish has been obtained. When this has dried, any surplus slurry material shall be broomed off the surface and disposed of as directed.
- 4.9.7 The base construction shall be approved prior to priming.
- 4.9.8 Prior to surfacing all underground public utilities service crossings shall be installed. All road crossings shall be backfilled and compacted in accordance with the requirements for sub-grade and sub-base construction.

#### **4.10 Primer Sealing Of Pavement**

- 4.10.1 The surface of the base course shall be primer sealed in accordance with Austroads publication "Bituminous Surfacing Volume 1, Sprayed Work 1989" prior to the application of the wearing course.
- 4.10.2 Sweeping -The surface of the base course shall be swept free from any loose material and dust in such a manner that will not damage the finished surface of the base course prior to the application of the binder.

#### 4.10.3 Application of Binder

In cases where a hot sprayed bitumen surface is specified, the primer seal shall be hot cut-back bitumen; for asphalt surfaces, either bitumen emulsion or hot cut-back bitumen as specified below may be used.

Primer sealing shall not be carried out for a period of at least 24 hours after completion of the water binding of the base course.

##### 4.10.3.1 Bitumen Emulsion

Bitumen emulsion in accordance with AS 1160-1988 shall be uniformly and evenly sprayed onto the existing surface at a rate determined by the design but shall not be less than 1.4 litres per square metre measured at 15 degrees Celsius.

##### 4.10.3.2 Hot Cut-Back Bitumen

Hot cut-back bitumen in accordance with AS2157-1980 'Cutback Bitumen' shall be applied at the rate determined by the design but shall not be less than 1.2 litres per square metre measured at 15 degrees Celsius, with the temperature of the bitumen being between 70 and 120 degrees Celsius.

##### 4.10.3.3 The Binder Application

The primer seal shall be applied by an approved mechanical sprayer. Where the direct use of a mechanical spray is impracticable, the binder may be sprayed using a hand lance fed from the mechanical sprayer.

#### 4.10.4 Application for Aggregate

4.10.4.1 The primer seal shall immediately after spraying be covered with approved 7mm nominal size aggregate as detailed in Section 6.3 "Specification for Sealing Aggregate" so that all sprayed areas shall be completely covered within a period of 15 minutes.

4.10.4.2 The aggregate shall be dry and free from dust and other deleterious material, and be spread by means of an approved aggregate spreader capable of spreading a uniform layer of aggregate.

4.10.4.3 Rate of application shall be determined by design but shall not exceed 150m<sup>2</sup> per cubic metre of metal, controlled so that only sufficient is applied to give a uniform dense mat of one stone thickness.

4.10.4.4 Within 5 minutes of the application of the aggregate, rolling shall commence using appropriate equipment and continue until the aggregate is well embedded in the binder and a uniform surface obtained.

#### **4.11 Hot Sprayed Bitumen Surfacing**

4.11.1 The application of a single coat aggregate wearing course to a surface which has been primer sealed in accordance with Section 4.10 shall be designed and carried out in accordance with Austroads publication "Bituminous Surfacing, Volume 1, Sprayed Work 1989". The wearing course shall be applied to those areas as shown on the approved drawings and shall consist of a hot bitumen binder with appropriate aggregate.

The Subdivider shall submit his proposed application rates for binder and aggregate for approval.

4.11.2 Before the binder is applied, the surface shall be swept free of all loose stones, dust, dirt and foreign material. Any sections of pavement that are loose or damaged shall be repaired and finished to the correct level.

#### **4.11.3 Materials**

The binder and medium curing cutting oil shall comply with AS 2008-1980 and AS2157-1980.

The proportion of medium curing cutting oil to be added to the binder shall be determined by the design and shall not to exceed 8%.

The aggregate shall consist of crushed stone as specified in Section 8.3 "Specification for Sealing Aggregate" and shall be of 14 mm nominal size.

#### **4.11.4 Application of Binder**

4.11.4.1 The Subdivider shall give the Engineer at least 48 hours notice of his intention to apply the binder and the approval shall be obtained before any spraying commences. The surface to be sealed shall be dry and no binder shall be applied whilst the pavement temperature is less than 25 degrees Celsius or during wet conditions, or when adverse weather conditions may prevail at any time during such work.

4.11.4.2 The binder shall be applied by an approved mechanical sprayer. Where the direct use of the mechanical sprayer is

impracticable, the binder may be applied by using a hand lance fed from the mechanical sprayer.

4.11.4.3 The binder edge shall not deviate from the desired edge lines by more than 50 mm. The rate of deviation of the binder edge from the desired edge lines shall not exceed one in four hundred (1:400).

4.11.4.4 All necessary precautions shall be taken to prevent over spray of binder. Any damage or defacement shall be made good immediately the sealing in that section has been completed, with all cleaning work being carried out to an acceptable standard.

#### 4.11.5 Application of Aggregate

4.11.5.1 The aggregate shall be dry and free from dust and other deleterious material at the time of application and shall be uniformly spread over the sprayed area by means of an approved type of mechanical spreader.

4.11.5.2 The time lag between spraying and spreading shall be kept to a minimum and all sprayed areas, with the exception of approved lapping strips, shall be covered with 14mm nominal size aggregate within ten (10) minutes of spraying the binder.

4.11.5.3 If there are surplus loose particles on any portion of the sealed area such portion shall be swept lightly so as to move the loose particles but not disturb the aggregate embedded in the binder.

4.11.5.4 Rate of application shall be determined by design but shall not exceed 70 m<sup>2</sup> per cubic metre of metal, controlled so that only sufficient is applied to give a uniform dense mat of one stone thickness.

4.11.5.5 Within 5 minutes of the application of the aggregate, rolling shall commence using appropriate equipment and continue until the aggregate is well embedded in the binder and a uniform surface obtained.

4.11.5.6 Any loose cover material not incorporated in the seal after the completion of rolling shall be removed from the seal surface as directed and disposed of in an approved manner.

#### 4.11.6 Measurement and Recording of Application Rates

##### 4.11.6.1 Binder

All loads of bitumen shall be sampled in accordance with AS 1160-1988, AS 2008-1980 or AS2157 –1980 as appropriate.

The following records shall be kept of all spray runs by a competent person and supplied to the Engineer:

- (a) Spray width
- (b) Start chainage – finish chainage
- (c) Side of road (left or right)
- (d) Road temperature
- (e) Bitumen temperature
- (f) Volume of bitumen used
- (g) Average bitumen application rate

#### 4.11.6.2 Aggregate

Aggregate volume shall be measured in truck at the point of spreading. Each load shall be levelled to facilitate calculation of volumes with the volume of the aggregate being recorded for each truck.

The actual application rate of cover aggregate shall be calculated from the measured volumes spread and the actual area measured on the site by the Consulting Engineer and supplied to the Engineer.

## 4.12 Concrete Kerbing

- 4.12.1 All concrete kerbing shall be cast in-situ using an extrusion machine to a cross sectional profile as shown on the approved drawings.
- 4.12.2 Appropriate measures shall be taken to ensure that kerbing is securely held in position. The laying of kerbing on the primed base course with asphalt placed against the front face and fill against the rear face is deemed to comply with this requirement. Provide a base key 150mm wide x 75mm deep under all kerbing laid to a radius of 50m or less.
- 4.12.3 All concrete work shall be carried out in accordance with AS3600-1988.
- 4.12.4 All concrete used shall be supplied in a ready mixed state and shall comply with the requirements of AS1379-1973. All concrete used in the works shall develop a minimum compressive strength of 20 MPa at 28 days with a maximum slump of 90mm.
- 4.12.5 The surface of the road shall be thoroughly swept clean of all loose material prior to the kerb being cast to ensure the maximum bond between the kerb and the pavement material.

#### 4.12.6 Tolerances

The line, level and radius of all kerbing shall be in accordance with the following tolerances:

- (a) The top surface of the kerb shall be parallel to the ruling grade of the pavement and shall be free from irregularities exceeding 5mm when measured with a 3m long straight edge.
- (b) Level +/- 5mm
- (c) Line +/- 10mm
- (d) Cross section dimensions +/- 5 mm.

4.12.7 The finished kerb shall be true to the cross-section dimensions specified and shall have a smooth finish.

#### 4.12.8 Contraction Joints

Contraction joints shall be constructed every 2.5 metres run of kerbing. The contraction joints shall be 6mm wide and shall be cut through the kerb above the road surface level immediately after extrusion. Care must be taken to avoid any disturbance to the edges of the joint and any such disturbance shall be made good immediately.

#### 4.12.9 Expansion Joints

Not less than 24 hours after placement of the kerb, expansion joints shall be formed by cutting completely through the kerb at 5.0 metre intervals, at sides of drainage gullies and at tangent points of all small radius horizontal curves. The expansion joints shall be 13mm wide. Each expansion joint will be filled with a foam packer which shall be covered with an approved compound.

#### 4.12.10 Curing

All concrete shall be cured as specified in AS3600-1988.

#### 4.12.11 Protection

All kerbing shall be protected from damage and any damage repaired immediately.



#### 4.12.12 Backfilling

The backfill material shall be free draining sand and/or topsoil, free from debris and deleterious matter and levelled and compacted to not less than 90% of the modified maximum dry density when tested in accordance with AS1289 E2.1-1977.

4.12.13 All surplus materials including materials removed due to non-compliance with the specifications shall be removed from the site and the area left in a neat and tidy condition.

### 4.13 Asphalt Surfacing

#### 4.13.1 General

Asphalt used for the wearing course on any road pavement shall consist of a combination of coarse aggregate, fine aggregate and mineral filler, uniformly coated and mixed with a bitumen binder in accordance with that detailed in Section 8.4 "Specification for Asphalt".

All work and material shall be in accordance with the requirements of AS 2734-1984 and shall provide a surface with level and roughness tolerances complying with the standard and having a compaction of at least 98% of the 50 blow, 35 blow or 25 blow Marshall density as approved.

#### 4.13.2 Commencement of Works

The Contractor shall give at least 24 hours notice to the Engineer before commencing or recommencing any asphalt surfacing works.

#### 4.13.3 Delivery Records

A weighbridge ticket showing the empty and loaded masses of the vehicle shall be made available to the Engineer at the point of delivery by the driver of the vehicle together with written confirmation of the following if requested:-

- (i) the date and time of loading
- (ii) the name of the supplier and the plant location
- (iii) the identification number of the vehicle
- (iv) the nominal size of the asphalt aggregate

#### 4.13.4 Testing of Asphalt

Test results indicating the following shall be supplied on request:

Marshall stability  
Marshall flow

Bitumen content  
% air voids  
% compaction

#### 4.14 Street Name Plates

4.14.1 The subdivider shall be responsible for the supply and erection of all street nameplates in accordance with AS1742.5 –1986 Part 5.

Nameplates shall be of approved type, be fully reflectorised on extruded aluminium and shall be erected at all newly created intersections and shall indicate the names of both streets. Nameplates and shall incorporate any special feature which may be required by Council (eg Shire logo, colours of legend and background, etc).

4.14.3 Depth of sign shall be 150mm with 100mm lettering except on major roads where a depth of 200mm with 150mm lettering shall be used.

4.14.4 Signs shall be mounted on 50mm diameter galvanised steel posts so that the bottom of the sign is 2.7 metres clear of the ground. Posts shall be concreted into the ground to a depth of at least 0.6 metres. The pole shall be erected on the 2.7 metre alignment.

Temporary “No Through Road” signs shall be erected on roads that have been temporarily terminated.

#### 4.15 Path And Island Paving

4.15.1 The paving material used in the construction of off-road paths and islands shall be 100mm thick cast “in situ” concrete. The finished surface shall be smooth and free from defects with a “broomed” non-skid finish. Contraction joints shall be provided every 2.0 metres. These shall be cut with an approved grooving tool and be 6mm wide. Expansion joints fitted with “Lock-Joint” shall be provided every 6.0 metres. Every 48 metres, a non “Lock-Joint” expansion joint shall be provided. These shall be 13mm wide and filled flush with an approved jointing material. Alternative equivalent paving materials may be used as approved.

4.15.2 All concrete work shall be carried out in accordance with AS3600-1988.

4.15.3 All concrete used shall be supplied in a ready mixed state and shall comply with the requirements of AS1379-1973. All concrete used in the works shall develop a minimum compressive strength of 20 MPa at 28 days with a maximum slump of 90 mm.

- 4.15.4 All paving to median islands shall be to the colour as specified by the Engineer.
- 4.15.5 The sub-grade under all paths shall be clean, well compacted sand fill. All concrete to median islands shall be placed on a compacted sand bed.
- 4.15.6 All public utility services shall be installed under paths and other paved areas prior to the paving work commencing.
- 4.15.7 The level of the finished concrete path shall suit the surrounding ground levels provided that the paved surface is free draining, with all path levels to be approved. Generally, all paths will have a 2% crossfall towards the road pavement.
- 4.15.8 The Subdivider shall give landowners whose verges will be affected by the path construction at least two (2) weeks notice of the commencement of the construction work.
- 4.15.9 All work shall be carried out in accordance with Council's requirements as appropriate and as detailed in its "Path Construction Specification."
- 4.15.10 Appropriate alterations to existing verge reticulation systems shall be carried out as part of the work at no extra cost.

#### **4.16 Lot Filling**

- 4.16.1 Where lot filling is required in accordance with these guidelines, the fill area shall be cleared and stripped of all organic material rubbish and any other deleterious material and the filling placed and compacted to the approved design levels.

The tolerances on lot filling shall be +/- 50mm.

- 4.16.2 The fill material shall be clean, free draining, medium to coarse sand, free from foreign and organic matter.
- 4.16.3 Topsoil shall be stockpiled for later re-spreading on batters and other disturbed surfaces where appropriate.
- 4.16.4 Material from clearing shall be disposed of away from the site of the works in a place and manner approved by Council. No material from clearing shall be deposited within the road reserve or on property beyond the boundaries of the subdivision without the owner's permission.

- 4.16.5 Adequate precautions must be taken to ensure no damage occurs to trees, vegetation, fences, services and other improvements outside the designated areas of the works. Survey pegs or marks which are disturbed shall be reinstated by a licensed surveyor at the Subdivider's expense.
- 4.16.6 All fill shall be compacted to the full depth with a density of 95% over the building envelope and 90% over the remainder of the fill area, of the modified maximum dry density when tested in accordance with AS 1289 E2.1-1977.
- 4.16.7 Where open drains across lots have been backfilled, the compaction of the backfill shall be in accordance with the preceding Clause and such areas shall be subject to special testing as determined by the Engineer.
- 4.16.8 The requirements for stabilisation, dust control and sand drift as detailed in Section 4.6 shall also apply to lot filling.
- 4.16.9 For urban subdivisions on a clay subgrade, the clay surface shall be sloped at a minimum grade of 1:100 towards a subsoil drainage line and covered with a minimum fill of 300mm of clean sand over the entire site. Clay being used as fill to achieve a uniform graded surface shall be compacted to 90% of the modified maximum dry density when tested in accordance with AS1289 E2.1-1977.



## **SECTION 5 – CONSTRUCTION OF DRAINS**

## 5. CONSTRUCTION OF DRAINAGE WORKS

### 5.1 General

5.1.1 All works shall be carried out in accordance with the Occupational Health, Safety and Welfare Act, 1984.

#### 5.1.2 Temporary Road Closure

Where it is necessary to close an existing road to carry out any part of the subdivisional works, approval for such closure shall be obtained from the Engineer at least (28) days prior to the work commencing.

The following conditions shall apply to such closures:

- (a) A suitable detour shall be determined and clearly signposted with approved signs for the duration of the works and if no such detour is available, suitable and passable side tracks shall be provided.
- (b) In the case of arterial roads and on other roads where a suitable and convenient detour is unavailable, the road closure shall be advertised by double column display advertisements in local newspapers advising the reason, location and duration of the closure and the route of the proposed detour, such advertisements being placed 21 days prior to the date of the proposed closure.
- (c) In the case of arterial roads and on other roads where a suitable and convenient detour is unavailable, advisory signs shall be erected at appropriate locations on the site 21 days prior to the closure, such signs to comprise a minimum 100 mm letter height and to advise the reason, location and duration of the road closure.
- (d) The works and road closure shall be adequately lit at night and other appropriate precautions shall be taken to ensure public safety.
- (e) Emergency services, schools, other large institutions and large businesses that may be affected by the closure shall be advised in writing of the reason, location and duration of the road closure and the route of the proposed detour at least 21 days prior to the closure.
- (f) The works shall be carried out in an expeditious manner to minimise the impact of the road closure on the general public.
- (g) Where the road closure is required by a private contractor to carry out works in the road reserve then the contractor must obtain approval from Council's Engineers prior to commencing the works.

## 5.2 Survey Set Out

- 5.2.1 All drainage works shall be set out and constructed in accordance with the alignments, levels and grades as shown in the approved drawings.
- 5.2.2 Care shall be taken when working in the vicinity of survey pegs and bench marks to ensure the accuracy thereof.
- 5.2.3 The Subdivider shall be responsible for the accuracy of the setting out of works.

## 5.3 Construction Tolerances

The tolerance for piped drainage lines shall generally be +/- 10mm for level and +/- 50 mm for line, but in all instances each section of drain shall be capable of carrying the design flow.

## 5.4 Materials

### 5.4.1 Pipes

5.4.1.1 Drainage pipes may be reinforced concrete, fibre reinforced cement, corrugated aluminium or plastic. Other types may be used on the approval of the Engineer.

5.4.1.2 All pipes shall conform to the appropriate Australian Standard, such as the following:

AS 1342-1973	Precast Concrete Pipes
AS1712 – 1976	Fibre Cement Pipes
AS1761 – 1985	Helical Corrugated
AS1762 – 1984	Steel Pipes
AS2566 - 1982	Plastic Pipelaying Design

5.4.1.3 Subsoil drainage pipes shall conform to the above but, except in the case of reinforced concrete pipes, shall have 250 mm by 5 mm slots cut through the pipe on alternate sides at 100 degrees so that the total length of slots is approximately half that of the pipe.

5.4.1.4 Reinforced concrete pipes shall be spigot and socket type unless otherwise approved.

#### 5.4.2 Concrete

5.4.2.1 Concrete used for in-situ work shall conform to AS3600-1988 and be provided by a pre-mix concrete supplier conforming with AS1379-1973 or mixed on site, using materials as specified and plant to the approval of the Engineer.

5.4.2.2 Concrete for manholes, headwalls, endwalls and keels shall have a minimum compressive strength of 20 MPa after 28 days. The slump shall not exceed 70 mm or be less than 30 mm. Maximum size of aggregate shall be 20mm.

#### 5.4.3 Cement

5.4.3.1 All cement used shall be Portland Cement in accordance with AS1315-1982 and obtained from an approved manufacturer.

5.4.3.2 Cement shall be delivered to the site fresh and in sealed bags and there stored in a weatherproof shed until such time that it is to be used. Any bag showing signs of deterioration or setting shall be rejected.

#### 5.4.4 Concrete Aggregate

5.4.4.1 Fine aggregate shall be well graded, clean, sharp and free from clay and organic impurities in accordance with AS2758.1-1985.

5.4.4.2 Coarse aggregate shall be crushed granite or diorite clear and free from all impurities in accordance with AS2758.1-1985.

#### 5.4.5 Water

5.4.5.1 Water for use in concrete and mortar shall be of potable quality, free from any impurities harmful to concrete mortar or steel.

#### 5.4.6 Sand

5.4.6.1 Sand for mortar will be crushed stone or natural sand free from all deleterious substances and have a uniform grading.

5.4.6.2 Sand for bedding or backfilling shall be clean sand free from roots, clay or any deleterious matter.



5.4.7 Steel

5.4.7.1 Steel reinforcing fabric and steel reinforcing bars for concrete shall comply with the requirements of AS1302-1977, AS1303-1973 and AS1304-1973 and be free from loose rust or matter likely to impair the bond with concrete.

5.4.7.2 Structural steel shall comply with the requirements of AS1205-1980.

5.4.8 Bricks

5.4.8.1 Bricks shall be hard, well burnt, pressed or wire cut clay bricks in accordance with AS1225-1984 having a minimum ultimate strength of 30 MPa and absorbing when saturated, not more than 10% of their own weight in water.

5.4.8.2 Bricks shall be of uniform shape and size, carefully conveyed and unloaded at the site. No chipped or broken bricks shall be used, and no pieces of brick to be used except where necessary as closures.

5.4.9 Calibrated Metal

5.4.9.1 Calibrated metal (granite or diorite) shall conform to the following sieve grading:

<u>Sieve Size</u>	<u>%Passing</u>
19.0	100
13.2	98-100
9.5	80-90
6.7	53-70
2.4	5-14
0.6	0-3

and be free from roots, clay and any deleterious material.

5.4.10 Manhole Liners

5.4.10.1 Manhole liners shall be circular precast concrete liners from approved manufacturers capable of withstanding anticipated design loadings.

5.4.11 Manhole Covers

5.4.11.1 Manhole covers located in the carriageway shall be equipped with purpose built reinforced concrete surrounds a minimum of 150mm thick and fitted with a "Gatic" or similar type cast iron frame and lid.

5.4.11.2 Manhole covers located elsewhere in the road reserve shall be equipped with a purpose built reinforced concrete surround 150mm thick.

5.4.11.3 All manhole covers shall be equipped with 600mm square or circular access point with tapered inserts. Both cover and insert shall have suitable lifting points installed.

5.4.11.4 Manhole covers located in easements on private allotments shall be of suitable thickness as determined by design loading but not less than 100mm.

#### 5.4.12 Grated Covers

5.4.12.1 Grated cover surrounds shall be 150mm thick reinforced concrete, 20 MPa at 28 days compressive strength concrete with sufficient reinforcement to withstand the design loading.

5.4.12.2 The steel insert shall be contained within a steel surround firmly embedded in the concrete and hinged on one side to permit opening with the steel surround protruding above the concrete surround by 25mm.

5.4.12.3 All grated gully covers shall be of a heavy duty construction and shall be load tested to full Austroads Highway Loading Conditions (90kN Wheel Load applied as per AS1597 Part 1-1974).

5.4.12.4 Grated covers shall have clear minimum internal dimension of 650mm x 490mm measured between and excluding the supporting angle frame.

5.4.12.5 Where there is any likelihood of cycle traffic crossing the road at right angles to the centreline of the road in the vicinity of gullies, 25mm x 3mm mild steel straps shall be welded to the bars at 100mm centres across the full length of the grate or other method as approved.

#### 5.4.13 Side Entry Kerb

Side entry kerb sections shall be reinforced concrete to a design submitted and approved by Council's Engineer.

### 5.5 Installation Of Manholes And Road Gullies

5.5.1 Manholes shall be constructed from either circular precast concrete sections or square/rectangular brickwork as determined by detailed design. Minimum thickness of brickwork shall be 230 mm.

- 5.5.2 The minimum internal size of all manholes shall be either 900 mm circular or square but in all cases the manhole shall be at least 600mm larger than the largest pipe connected to the manhole. The minimum manhole diameter in private property shall be 750mm.
- 5.5.3 All manhole covers shall overhang the liner or walls by 100mm minimum. The tops of all manholes shall be flush with either the pavement level or the finished ground level and set at appropriate cross falls where necessary.
- 5.5.4 Manholes shall be embedded on sand compacted not less than 95% of the maximum dry density when tested in accordance with AS1289.E2.1-1977.
- 5.5.5 Steel step irons shall be installed in the walls of all manholes over 1.2 metres deep at approximately 400mm spacing or at every fifth course of brickwork. Step irons shall be of an approved design with a minimum diameter of 12mm. The surface of these steps be adequately protected against rust by galvanising or similar treatment.
- 5.5.6 Road gullies shall be of either a side entry pit design, a steel grate design or a combination of both.
- 5.5.7 All manholes located in the road reserve shall have bases of 150mm thick reinforced concrete, 20MPa at 28 days compressive strength concrete with sufficient reinforcement to withstand the design loading.
- 5.5.8 The grated cover shall be installed with the bars at right angles to the road centreline.
- 5.5.9 Side entry pits shall be created by installing a precast kerb section fitted with an opening into the kerblines. The minimum depth of the opening shall be 100mm.
- 5.5.10 The side entry kerb shall be located directly above the manhole wall such that the water flows directly from the water channel into the manhole.
- 5.5.11 The road pavement in the vicinity of the side entry pit shall be shaped to facilitate the ingress of water by forming an evenly graded depression, the maximum depth of which shall be 50mm at the face of kerb in the centre of the opening in the kerb section, constructed in such a manner that does not reduce the serviceability of the road pavement.
- 5.5.12 Manholes installed on the drainage lines 600mm diameter and over shall not be fitted with side entry inlets.

- 5.5.13 The road-wearing surface shall extend over grated gully surrounds. Gully grates shall be installed 25mm proud of the primed road surface in order to be flush with wearing surface.

## **5.6 Headwalls And Endwalls**

- 5.6.1 Where a piped drain interfaces with an open drain, a suitable endwall structure shall be provided to prevent the entry of loose material into the pipe and the erosion of surrounding ground. In the case of pipes exceeding 600mm diameter, suitable structures shall be fitted to the inlet to the pipe drainage system to prevent access.
- 5.6.2 All headwalls and endwalls shall be constructed using either concrete with 20 MPa compressive strength, mortared stonework or brickwork.
- 5.6.3 For mortared stonework each stone shall weigh in excess of 10 kg and the greatest dimension of any stone shall not exceed 1.5 times its least dimension.
- 5.6.4 Endwalls located on outlet pipes exceeding 300mm diameter shall include suitable erosion protection in the form of aprons and edge beams.

## **5.7 Pipe Laying**

- 5.7.1 Pipes shall not be laid on filled ground until such ground has been compacted to a minimum of 95% of its modified maximum dry density when tested in accordance with AS 1289.E2.1-1977.
- 5.7.2 Trenches shall be excavated to the dimensions shown on the approved drawings to the minimum consistent with bed width requirements.
- 5.7.3 In the case of rock occurring in the bottom of the trench, the trench shall be excavated to a depth of at least 200mm below the design levels, backfilled with clean sand fill and compacted as specified in Clause 5.7.1.
- 5.7.4 All blasting shall be carried out in accordance with Clause 4.5.6.
- 5.7.5 Free water in excavations shall be controlled to a level sufficiently low so as not to interfere with the construction work.
- 5.7.6 The trenches shall be cut to the line, depth and gradient required. If any pipe trench is excavated deeper than required, the extra depth shall be filled with sand and compacted to a density comparable to that of the natural surrounding material.

- 5.7.7 Any excavation which is carried out in public or private roads shall be arranged so that pedestrian and vehicle access is maintained at all times unless this is considered highly impractical, in which case work shall be arranged to cause the minimum disruption possible.
- 5.7.8 Pipes shall be laid true to the design lines and levels as shown on the approved drawings and shall be laid so that the pipes will be bearing uniformly on the foundation for their entire length.
- 5.7.9 All pipes shall be jointed in accordance with the manufacturer's recommendations unless specified otherwise.
- 5.7.10 No damaged pipe shall be used in the works.
- 5.7.11 All pipe laying and jointing shall be inspected and approval given before backfilling or metalling commences. Any work that is covered before being so approved, shall be uncovered if so directed.
- 5.7.12 Slotted pipes shall be laid with the slots in the down position symmetrical about the vertical centre line.
- 5.7.13 Calibrated metal as previously specified shall be placed along the full length of all subsoil pipes and inspected prior to backfilling.
- 5.7.14 The trenches shall be backfilled using clean coarse sand filling free from clods or stones and effectively free draining. This backfilling material shall be compacted evenly around manholes and gullies and over and around pipes. Compaction shall be 95% under paved areas and within the building envelope, and 90% elsewhere of the modified dry density when tested in accordance with AS1289-1977 E2.1.
- 5.7.15 Any surplus excavated material shall be disposed of in an approved manner.
- 5.7.16 All pipes protruding into gullies and manholes shall be trimmed to be flush with the internal face of the structure and any irregularities and depressions filled with an approved grouting material.
- 5.7.17 Where a drain is to be laid on unsound ground, or if the drain crosses over a sewer line or other essential services, the pipe shall be laid on a suitable independent support structure.
- 5.7.18 All backfilling shall be placed with great care in such a way that no pipes or joints or other works are displaced or damaged.
- 5.7.19 During construction no sand or other material shall find its way into the drainage system. Unfinished manholes shall be covered to prevent this occurring.

5.7.20 The backfilling and interim restoration of the trenches in existing road pavements shall be completed immediately after acceptance of piping work. The material used for backfilling pipe trenches and the pits in roadways shall be a clean granular material and shall be compacted to a density not less than 95% of the maximum dry density as tested in accordance with AS1289 E2.1 1977. The top 300mm of trench shall be filled with limestone to surface level and compacted as specified herein. The surface of the trenches shall be kept in safe and reasonable condition for traffic until permanent road reinstatement is carried out. All subsidence shall be made good with fresh approved material. Unless otherwise stated interim restoration and maintenance of private roads or right of ways shall be carried out in the same manner as if they were public roads. The remainder of the reinstatement shall be carried out by Council unless otherwise approved.

5.7.21 The surface of verges and all other similar land shall be restored to the condition in which it was found and shall be left with the surrounding ground level after all consolidation has been completed. The surface soil and sub-soils shall be stored separately and afterwards reinstated in their natural order. All areas disturbed by drainage works shall be stabilised in accordance with Section 4.6 of this specification.

## **5.8 Open Drains**

5.8.1 Open drains shall be installed to the lines and levels shown on the approved drawings.

5.8.2 Excavated material from open drains shall be disposed of in an approved manner.

5.8.3 Where over excavation occurs, this shall be corrected by filling with in-situ material and compacting to a density comparable to that of the natural surrounding material.

5.8.4 A corridor 3.0 metres wide shall be provided for future maintenance access along one side of the drain.



## **SECTION 6 – SUPERVISION**

## 6. CONTROL & SUPERVISION OF CONSTRUCTION

### 6.1

All subdivision works shall be designed and constructed in accordance with sound engineering principles and in compliance with the approved drawings and specifications.

Final approval for the works shall only be given when the whole of the works shown on the drawings of subdivision have been executed to the true intent and meaning of the approved drawings and specifications and to the satisfaction of Council's Engineer.

### 6.2 Responsibility for Quality of Construction

Irrespective of any approvals given by Council's Engineer, the Subdivider and his responsible agents (including where applicable the Consulting Engineer and/or the Contractor) shall remain fully responsible for the quality of the works. The inspections, checks and tests to be carried out by Council's Engineer are not intended to be comprehensive or detailed and do not take the place of comprehensive superintendence of the works by the Subdivider's Consulting Engineer.

All subdivision works shall be subject to the provisions of AS 2990 "Quality Systems for Engineering and Construction Projects" and AS 3900 to 3904 "Quality Systems". The quality assurance category to be adopted should be Category C generally with only critical aspects to be subject to Category B requirements. The Consultant shall ensure that all contract work complies with these provisions.

### 6.3 Schedule of Inspections

Inspections by Council's Engineer or his representative shall be required at the following stages of construction. A minimum of two working days notice shall be given by the Subdivider's Consultant that inspections are required:

#### Roads

- (a) when the road has been boxed out and the subgrade shaped and compacted.
- (b) after the sub-base has been placed, graded and compacted to shape and level.
- (c) when the base has been placed, graded, compacted and waterbound to correct shape and level.
- (d) before and during the priming operation
- (e) during laying of concrete kerbing.
- (f) before and during the placement of asphalt or sprayed surface course.

#### Drains

- (a) when the trenches have been excavated and the pipes laid to true line and level.
- (b) when using sub-soil pipes, after the calibrated metal has been placed



- (c) after manholes, gullies and other structures have been built and backfilling of all trenches completed.

No second or follow up stage of construction shall proceed until approval has been given for the preceding stage.

Representatives of the Consultant and the Contractor shall be present at stage inspections if requested by Council's Engineer.

#### 6.4 Testing & As Constructed Surveys

All test results and as constructed surveys taken during the works, whether required under this part or not, shall be made available to Council's Engineer. All materials and compaction tests shall be carried out by a NATA approved testing laboratory. All as constructed surveys shall be carried out by an independent licensed surveyor. Works which fail to meet specified criteria shall be corrected and re-tested or re-surveyed, as the case may be.

The following minimum tests shall be required:

- (a) Grading and testing of properties of representative samples of sub-base and basecourse materials prior to commencement of supply of those materials;
- (b) In situ density testing -
  - embankment filling: 4 tests per 1 000m<sup>3</sup>
  - sub-base & basecourse: 4 tests per 500m<sup>3</sup>

Additional density tests of foundation and subgrade to road pavements shall be taken at the Subdivider's cost when requested by Council's Engineer.

The following minimum as constructed surveys shall be required:

- (a) After completion of subgrade preparation and prior to cartage of base courses, take levels at no greater than 20m intervals on the centreline and on both edges of pavement boxing. The as constructed information shall be presented in plan or tabular form showing the chainage, the design subgrade levels for each point, the as constructed levels and the difference between the two.
- (b) After completion of sub-basecourse construction and basecourse construction, and prior to surfacing (sealing), take levels at no greater than 20m intervals on the centreline (at chainages to match subgrade levels) and on both edges of basecourse. The as constructed information shall be presented in plan or tabular form showing the chainage, the design basecourse levels for each point, the as constructed levels and the difference between the two.
- (c) Pipe drain systems and open drains (not including table drains). Details shall include location and size of pipes and drains, length between ends (or centreline distances to pits etc), lid or cover levels where appropriate, and invert levels at ends. For open drains bottom widths, invert levels at no greater than 20m intervals and side slopes shall additionally be required.

## **6.5 Practical Completion**

Any items of work found to require rectification at the time of the practical completion inspection, or at any time thereafter, shall be rectified before practical completion will be certified by Council's Engineer.

When all subdivisional works are completed to the satisfaction of Council's Engineer, the Consultant shall be notified of the practical completion date.

If at any time after the granting of practical completion the subdivisional work is found to be contrary to Council's requirements, or is found to have been constructed in error to the approved drawings, specifications and any instructions which may have been issued by the Consultant or Council's Engineer during the course of construction, then the works shall be rectified at no cost to the Council. Minor rectification items may be undertaken at the completion of the maintenance period.



## **SECTION 7 – MAINTENANCE AND SURVEY RELEASE**

## 7. MAINTENANCE & RELEASE

### 7.1 Survey Release

The Consultant shall satisfy Council that the Subdivider has complied with all relevant conditions imposed by the Western Australian Planning Commission pertaining to survey release of all or part of a constructed subdivision.

The conditions which must be complied with by the Subdivider prior to the Council's approval of survey release of a subdivision shall include, but shall not necessarily be limited to, the following:

- (a) Creation and location of all stormwater drainage easements;
- (b) Creation of any other easements (temporary or permanent) which are relevant to the subdivision;
- (c) Creation of all reserves (including drainage and recreation reserves) pertaining to the subdivisional works;
- (d) Payment of all moneys required to be paid to the Council in consideration of construction of footpaths, footways or any other works associated with the subdivision and which are to be carried out by the Council;
- (e) Payment of any maintenance retention money and payment of supervision fees required by the Council;
- (f) Stabilisation of topsoil, sand or other material or matter subject to movement over or near the subdivision shall be completed to the satisfaction of Council's Engineer;
- (g) Completion of all roadworks and other works associated with the subdivision construction to the stage of practical completion;
- (h) Such drawings shall be on a reproducible material, and show the location of all drains and services.

### 7.2 Maintenance

A twenty four months defects liability period shall apply from the date of practical completion of the subdivisional works.

During the period the Subdivider and/or his responsible agents shall be responsible for rectification of any defects, whether they are construction or design defects, which may become apparent. The Subdivider or his responsible agents shall carry out rectification work within the time requested by Council when notified of such defects.

If defects are not rectified within the time required by Council then Council may have the defects rectified at the Subdivider's expense. In this case the cost of the work shall become a debt due to the Council and Council may draw on any retention money being held, without reference to or approval from the Subdivider and without limiting its right to recover any balance of money due should the security be insufficient to cover the costs of the works.

Before practical completion is granted the Subdivider shall lodge with the Council an amount of 5% of the cost of the works as security for ensuring the rectification of defect, which shall be retained by Council for the duration of the defects liability period.

Any defects rectified during the defects liability period shall be subject to a further 12 months defects liability period. During this further period Council may, at its discretion, withhold the release of all or part of any security.

Retention money shall only be released at the expiration of the defects liability period (or any further period) after satisfactory rectification of all defects.



## **SECTION 8 – MATERIAL SPECIFICATIONS**

## 8. MATERIAL SPECIFICATIONS

### 8.1 SPECIFICATION FOR CRUSHED LIMESTONE

#### 8.1.1 General

Crushed limestone shall be limestone obtained from an approved source and be crushed to comply with the grading in this specification.

The crushed limestone shall be free from:

- (a) roots and other organic matter; and
- (b) sand, capstone and other deleterious material

#### 8.1.2 Testing

Methods of sampling and testing of crushed limestone shall in accordance with the following Australian Standards:

AS1141-1974  
AS1289-1977.

#### 8.1.3 Properties

The crushed limestone shall have a resistance to abrasion, when determined in accordance with the Los Angeles Test to show a weight loss not exceeding sixty (60) percent by weight.

The Calcium Carbonate content of the crushed limestone shall not be less than eighty (80) percent by weight.

#### 8.1.4 Grading

The crushed limestone for sub-base shall comply with the following grading requirements.

<u>Sieve Size</u> <u>(Square Openings As Sieve)</u>	<u>Percentage Passing By Weight</u>
75 mm	100%
19mm	50-75%
2.36mm and less	30-50%

## 8.2 SPECIFICATION FOR ROAD BASE

### 8.2.1 General

The road base material shall consist of a combination of soil binder, sand and gravel and shall conform with this specification. It shall be free of vegetable matter and lumps or balls of clay and shall not contain objectionable quantities of pyrites or other deleterious substances.

Coarse aggregate retained on a 2.36mm sieve shall consist of hard, durable particles or fragments of gravel; materials that break up when alternatively wetted and dried shall not be used.

Coarse aggregate shall have a percentage wear by the Los Angeles Abrasion Test of not more than forty-five (45).

Fine aggregate passing a 2.36mm sieve shall consist of natural or crushed sand and fine mineral particles passing the 0.075mm sieve.

The ratio of the portion passing the 0.075mm sieve to the portion passing 0.425mm sieve shall fall within the range 40-60%.

### 8.2.2 Properties

The portion of the sample which passes the 0.425mm sieve (Soil Mortar) shall conform to the following requirements when tested in accordance with AS1289-1977:

Plastic limit shall not exceed	20
Liquid limit shall not exceed	25
Plasticity Index shall not exceed	5
Linear Shrinkage shall not exceed	1%
Dry Compressive Strength shall not be less than	1.75MPa
Dust ratio shall not exceed	0.67

### 8.2.3 Grading

When tested in accordance with AS1289-1977, the grading of the gravel shall conform to the following requirements:



Sieve Size (Square Opening AS Sieve)	Percent by Weight Passing
19mm	95 – 100%
13mm	75 – 85%
9.5mm	65 – 75%
4.75mm	40 – 60%
2.36mm	30 – 50%
1.18mm	20 – 40%
0.425mm	10 – 30%
0.150mm	5 – 15%
0.075mm	2 – 10%

### 8.3 SPECIFICATION FOR SEALING AGGREGATE

#### 8.3.1 Aggregate

The aggregate shall be crushed diorite or granite consisting of clean, washed, tough, durable fragments free from an excess of thin or elongated pieces, free from soft or disintegrated pieces, stone coated with dirt, dust or other deleterious matter.

#### 8.3.2 Particle Shape

The proportion of flat or elongated particles in any grading of coarse aggregate shall not exceed 20 percent. A flat particle is one having a ratio of width to thickness of greater than three and an elongated particle is one having a ration of length to width greater than three. There shall not be more than 2.5% of particles of greater length in any direction than twice the gauge, and there shall not be more than 20% of particles of greater dimensions in any direction than 25% in excess of the gauge.

#### 8.3.3 Hardness

Wear – the aggregate shall have a Los Angeles abrasion value not exceeding 20% of wear for diorite and not exceeding 40% for granite.

#### 8.3.4 Specific Gravity

The bulk specific gravity of the particles of diorite shall be not less than 2.90 (2.60 for granite).

8.3.5 Elongation Factor

The elongation factor which shall be defined as the ratio of the average long dimension to the average least dimension shall not exceed 2.75 for the sample.

8.3.6 Method of Sampling and Testing

The method of testing the road metal shall be in accordance with AS1141-1974.

8.3.7 Grading Requirements – (Percentage by Weight)

Size No.	1	2	3	4	5	6
NORMAL SIZE	25mm	20mm	14mm	10mm	5mm	3mm
Passing A.S.mm Sieve						
37.5	100					
26.5	80 -100					
19	0 -20	100				
16	0 -2	80 -100	100			
13.2		0 -20	80 -100	100		
9.5		0 -2	0 -20	80 -100		
6.7			0 -2	0 -25	100	
4.75				0 -2	80 -100	100
2.36					0 -30	80 -100
1.18	0 -0.5	0 -0.5	0 -0.5	0 -0.5	0 -0.5	0 -30
600 micron						0 -5

8.3.8 Average Least Dimension Requirements

SIZE NO.	1	2	3	4	5
Average Least Dimension	15 - 25	10 - 18	9 - 13	6 - 8	4 - 6

8.4 SPECIFICATION FOR ASPHALT (BITUMINIOUS CONCRETE)

8.4.1 General

All asphalt used in paving works shall comply with AS2734-1984.

8.4.2 Binder

The binder shall be Class 170 residual asphaltic bitumen complying with AS2008-1980.

8.4.3 Aggregate

The aggregate shall be granite and be in accordance with Appendix "K" of AS2150-1978.

8.4.4 Characteristics of the Paving Mixture

The paving mixture for the surface course shall meet the following requirements by weight when determined by A.S. sieves. The residual binder, that is the residual asphaltic bitumen, shall be determined as a percentage by weight of the total mixture.

SIEVE SIZE	PERCENTAGE OF MINERAL AGGREGATE PASSING SIEVE (by weight)			
	AC5	AC7	AC10	AC14
19.0 mm	-	-	-	100
13.2 mm	-	-	100	85 – 100
9.50 mm	-	100	90 – 100	70 – 85
6.70 mm	100	80 – 100	70 – 90	62 – 75
4.75 mm	85 – 100	70 – 90	58 – 76	53 – 70
2.36 mm	55 – 75	45 – 60	40 – 58	35 – 52
1.18 mm	38 – 57	35 – 60	27 – 44	24 – 40
600 um	26 – 43	22 – 35	17 – 35	15 – 30
300 um	15 – 28	14 – 25	11 – 24	10 – 24
150 un	8 – 18	8 – 16	7 – 16	7 – 16
75 un	4 – 11	5 – 8	4 – 7	4 – 7
General limits of bitumen content	5.5 – 7.0	5.3 – 7.0	5.3 – 7.0	4.8 – 6.5

8.4.5 Marshall Properties

PROPERTY	MIX			
	AC5	AC7	AC10	AC14
Minimum Marshall Stability (50 blow)	5.0 kN	5.5 kN	6.5kN	6.5kN
Marshall flow (50 blow)	2 – 4 mm	2 – 4 mm	2 – 4 mm	2 – 4 mm
Voids Content	3 – 5%	3 – 5%	3 – 5%	3 – 5%
Bitumen Content	5.5 – 7.0%	5.3 – 7.0%	5.3 – 7.0%	4.8 – 6.5%